

# Operation Manual

## F4





EP EQUIPMENT CO.,LTD. is one of the world's leading companies manufacture, design material handling equipment and provide related service. With over 100,000 square metres plant it produces over 100,000 trucks per year, and provides professional, effective and optimized material handling solutions worldwide, until now it has developed three major kinds of business:

- Material handling equipment: Focus on electric forklift and warehouse equipment
- OEM parts: Global parts supply
- Imow industry,online: One-stop industrial products supply

Guided by our customer-oriented concept, EP has developed service centers in more than 30 countries around the world, from which customers are able to receive timely local service. Moreover, 95% of warranty parts can be shipped out within 24 hours after been ordered. Through our online after-sales service system, customers can process their warranty claims, order spare parts and consult the operation manuals, maintenance materials and spare parts catalogs.

With business all over the world, EP has thousands of employees and hundreds of agents worldwide to provide our global customers with prompt local service.

Based on the concept of sharing economy , EP also offer rental service for various logistics equipment. Adhering to the idea “Making the leasing of logistic equipment more simple”, EP is devoted to providing customized one-stop leasing solutions for our customers with our high quality, reasonable price and prompt rental service.

EP's mission&vision is “ Let more people apply the electrical material handling equipment to relieve the intensity of labour” and “Let's grow together”.

EP EQUIPMENT CO., LTD  
 Address: No.1 Xiaquan Village,  
 Lingfeng Street, Anji, Huzhou,  
 Zhejiang  
 Tel: + 86-0571-28023920  
 Website: [www.ep-ep.com](http://www.ep-ep.com)  
 Email: [service@ep-ep.com](mailto:service@ep-ep.com)

## Preface ►

Thank you for buying our products.

The manual will show you the way of correctly using the truck as well as relevant preventive maintenance and safety operation. The truck should be operated only by well-trained professionals and by no means by non-working personnel. Operators are supposed to read through the manual before actually operating the truck.

### ● Explanations on the manual

With the continuous upgradation and improvement of our company's products, you may find a slight difference existing between your carrier and some introductions in the manual.

All the information, specifications and illustrations in the manual are effective in times of printing and our company maintains the right to modify the specification (s) or design (s) of our products at any time without any beforehand notification.

### ● Safety signs and corresponding explanations



#### **DANGER**

Means that failure to comply can cause risk to life and/or major damage to property.



#### **WARNING**

Please strictly adhere to these safety instructions to avoid personal injury or major damage to equipment.



#### **CAUTION**

Please pay attention to the important safety instructions.



#### **NOTE**

Pay attention to Instruction.

### Internet address and QR code of Parts manual

By entering the address <http://www.ep-care.com> in a web browser or by scanning the QR code, Login after registration, Select "Parts purchase" function and input part number or model name to find the truck.



**NOTE:** After registration, please send email to [info@ep-care.com](mailto:info@ep-care.com) to activate your account

## Intended use ►

**The truck is designed for transporting and lifting the loads stated in the nameplate.**

**In particular we refer to:**

- the safety rules of your trade association.
- In accordance with the special provisions for driving on public roads specified by national specifications.
- Other local regulations.

The rules for the intended and approved use of industrial trucks must be followed under all circumstances by the responsible persons, especially by the operator and service personnel.

The user, and not manufacturer is responsible for any danger arising from applications not authorised by the manufacturer.

If you want to use the truck for applications not mentioned in this manual, please first contact your authorised dealer.

No changes, particularly no modifications and additions, may be made to the truck without the approval of the manufacturer.

### ► Technical description

- The truck consists of robust steel chassis and is driving on a traction wheel and 2 load wheels, providing for good stability even with high loads.
- The truck will be stopped by a regenerative service brake and hold by an automatic electromagnetic parking brake in it's parking position.
- The load is lifted by a hydraulic cylinder that activates a lifting shaft that transmits the lifting movement by a push-rod to the load wheels.
- The F4 can be equipped with two kinds of control hand. The control handle is used for smooth steering and control of drive speed, lifting and lowering, braking and the horn without changing the position of the hand. The long tiller shaft allows effortless steering and a safe distance to the truck. A spring returns the control handle always into a vertical position that activates the brake automatically.
- The F4 can be equipped with two lithium-ion battery , when the one is low power, it can be removed from side effortlessly, the rest battery can still support the truck to work.
- An electronic controller operates all electric functions and guaranties safety.
- Adopted single-cylinder two-connecting rod structure is simple and reliable, with good lifting synchronism.
- A key switch secures the truck from unauthorized use.
- The ergonomic design of the truck guaranties safe and easy operation.

### ► Schematic views

This manual is used for operation and maintenance, the detail parameters, size and specifications in context is only for reference , the real parameters will depend on sale files.

Manual pictures for reference only, the real car shall prevail, and shall not affect the manual use.

Manual pictures only sign for one of the models in this series models.

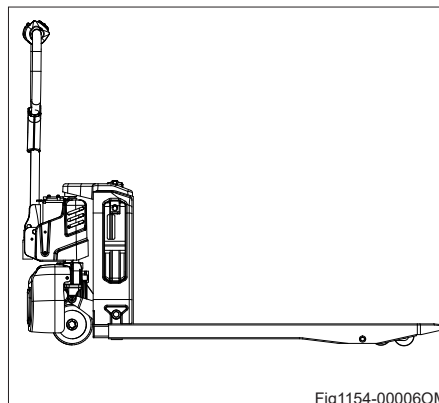

Fig1154-00006OM



## ● Obligations and responsibilities of equipment user

In the manual, “equipment user” refers to any natural person or legal person directly using or appointing or authorizing others to use the carrier. In such special situations as renting or sales, the “equipment user” represents the interested parties supposed to bear operation obligations as specified by the contractual terms concluded between equipment owner and corresponding users. Equipment users must ensure the use of the carrier only for purposes specified and timely eliminate all the dangers that may threaten the life and health of the users themselves or any other third party, in addition to which they must also strictly abide by accident prevention provisions, other safety technology provisions and equipment operation, maintenance and repair guidelines, and ensure that all the operators seriously read and completely understand the contents of the operation instruction.

Should any violation of the operation instruction occur, the quality guarantee of our company will be invalid automatically, and our company will assume none of the responsibilities for losses resulting from any nonstandard operation of the equipment implemented by any client, equipment user or any third party without the authorization of the client service department of our company.

## ● Modification

Unauthorized modification to the truck can result in injury or death.

Can not remove, disable or modify any safeguards or other safety devices.

Exception: Only in the event that the truck manufacturer is no longer in business and there is no successor in the interest to the business, may the user arrange for a modification or alteration to a powered industrial truck, provided, however, that the user

- a) arranges for the modification or alteration to be designed, tested and implemented by an engineer(s) expert in industrial trucks and their safety.
- b) maintains a permanent record of the design, test(s) and implementation of the modification or alteration.
- c) approves and makes appropriate changes to the capacity plate(s), decals, tags and operation manual.
- d) affixes a permanent and readily visible label to the truck stating the manner in which the truck has been modified or altered, together with the date of the modification or alteration and the name and address of the organization that accomplished those tasks.

## ● Wind loads

Wind forces can affect the stability of a truck when lifting, lowering and transporting loads with large surface areas .

Light loads must be especially secured when they are subjected to wind forces. This will prevent the load from sliding or falling.

Stop the truck in both cases.

## Frame installation ►

- Install the front and rear frame before operating the truck for the first time.
- Put the front frame (1) under the rear frame (2) and insert the cylinder (3) into the cylinder block (4);
- Connect the harness and wires;
- Screw six bolts (6) to connect the rod and drive axle.
- Install the batteries (7) of both side.
- Now the truck can be operated. Follow chapter B Section 1.3.2 Commissioning.

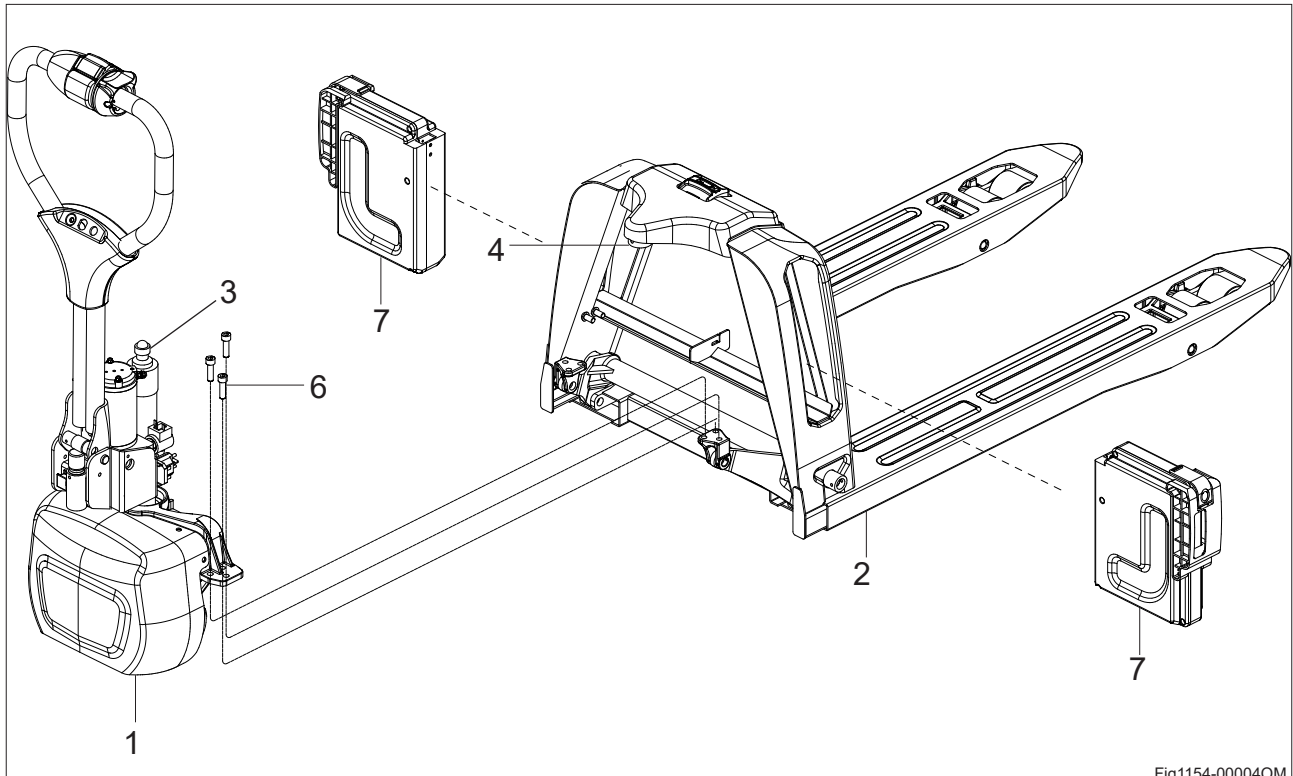

Fig1154-00004OM

## Legal requirements for marketing

### Declaration

EP EQUIPMENT CO., LTD.

Address: No.1 Xiaquan Village, Lingfeng Street, Anji, Huzhou, Zhejiang

We declare that the machine

Industrial truck: according to this operation manual

Type: according to this operation manual

complies with the most recent version of Machinery Directive 2006/42/EC.

Personnel authorised to compile the technical documents:

See EC/EU Declaration of Conformity

EP EQUIPMENT CO., LTD.

### EC/EU Declaration of Conformity

The manufacturer declares that this industrial truck complies with the EC Machinery Directive and the provisions of other applicable EC/EU directives effective at the time of sale. This can be verified by means of the EC/EU Declaration of Conformity and the relevant certification label on the nameplate.

The industrial truck is supplied with the EC/EU Declaration of Conformity document. This declaration proves that this truck complies with the requirements of the EC Machinery Directive. Unauthorised modification or additional installation of equipment to the structure of the industrial truck may affect its safety, and will therefore invalidate the EC/EU Declaration of Conformity.

The EC/EU Declaration of Conformity must be carefully stored and made available to be presented to the relevant authorities when necessary. If this industrial truck is sold, this declaration document must be handed over to the new owner.

## Table of contents

	Pg.
A Nameplates and alarming labels .....	A1
B Operation .....	B1
1.1 Utilization safety specification .....	B1
1.1.1 EN standards .....	B2
1.1.2 Conditions for application .....	B3
1.1.3 Stability .....	B3
1.2 Display and Manipulation .....	B4
1.2.1 Truck overview .....	B4
1.2.2 Control handle .....	B5
1.2.3 Key switch .....	B6
1.2.4 Display instrument .....	B6
1.3 Truck use and operation .....	B7
1.3.1 Preparation for use .....	B7
1.3.2 Commissioning .....	B8
1.3.3 Truck starting .....	B9
1.3.4 Running, steering and braking .....	B10
1.3.5 Goods picking .....	B14
1.3.6 Parking the truck securely .....	B15
1.3.7 Drive directions .....	B16
1.3.8 Loading .....	B17
1.3.9 Using the truck on a slope .....	B18
1.3.10 Truck transport .....	B19
1.3.11 How to remove a broken truck .....	B20
1.3.12 Operating the truck without its own drive system .....	B21
C Battery use and maintenance .....	C1
1.1 Battery charging .....	C3
1.1.1 Precautions .....	C3
1.1.2 Charging the battery with external charger .....	C3
1.1.3 Battery type & dimensions & Charging time .....	C3
1.2 Battery removal and installation .....	C3
D Maintenance .....	D1
1.1 Truck maintenance .....	D1
1.2 Maintenance table .....	D5
1.3 Maintenance Instructions .....	D7
1.3.1 Prepare the truck for maintenance and repairs .....	D7
1.3.2 Remove the cover .....	D7
1.3.3 How to add hydraulic oil .....	D8
1.3.4 How to add grease .....	D8
1.3.5 Checking the fuses .....	D8
1.4 Recommissioning .....	D8
1.5 Final decommissioning, disposal .....	D8
1.6 Tire replacement .....	D8
E Technical data .....	E1
F Lithium batteries .....	F1
1 Information on the conformity of lithium-ion batteries .....	F2
2 It is necessary to respect the following guidelines .....	F2
3 Intended use .....	F2
4 Reasonably foreseeable misuse .....	F2
5 Accessories .....	F3
6 BMS (Battery Management System) .....	F3
7 Nameplate .....	F3
7.1 Safety and warning .....	F3



## Table of contents

	Pg.
8 Transportation.....	F5
8.1 Shipping faulty batteries .....	F5
9 Instructions for disposal.....	F6
10 Charging .....	F6
11 Storage .....	F7
12 Common Problems and Solutions .....	F7

# A

## 1.1 Nameplates and alarming labels

- Have the nameplates of a truck fixed its main body and alarming labels pasted on its outer cover.
- Should any nameplate or alarming label lose or be damaged, please conduct replacement immediately or contact with the sales department or corresponding agent of our company when necessary.
- Such truck-related information as product model, serial number, manufacturing date, rated load lifting capacity, lifting height, load centre distance and dead weight are all shown in the nameplates.

### ➤ Alarming labels

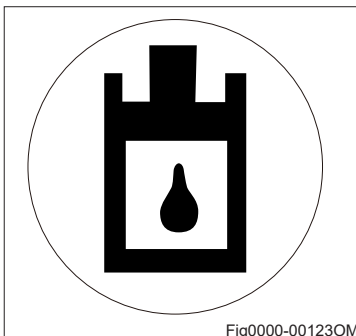

Hydraulic oil port



Do not rest on  
the pallet truck  
label



Anti-pinch hand  
label



Read operation  
manual label

## ➤ Nameplate

Item	Description
1	PRODUCT NAME
2	MODEL TYPE
3	SERIAL NO.
4	MANUFACTURE DATE
5	LIFT HEIGHT
6	UNLADEN MASS
7	UNLADEN MASS WITHOUT BATTERY
8	BATTERY VOLTAGE
9	RATED DRIVE POWER
10	MAX BATTERY WEIGHT
11	MIN BATTERY WEIGHT
12	RATED CAPACITY
13	LOAD CENTER

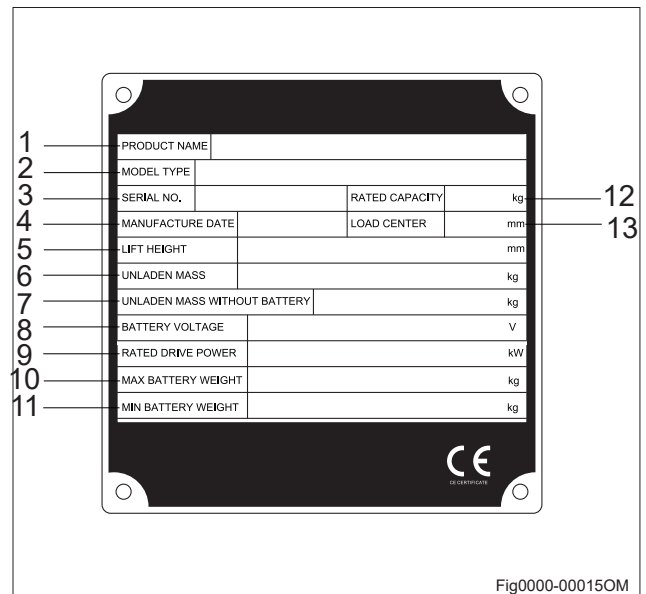

## ➤ Hoisting

Remove the load before hoisting the pallet truck.

Disconnect the power supply.

Attach slings in the positions identified by the hook symbol.



## DANGER

*Personnel must not stand below or near the truck when the pallet truck is being lifted.*

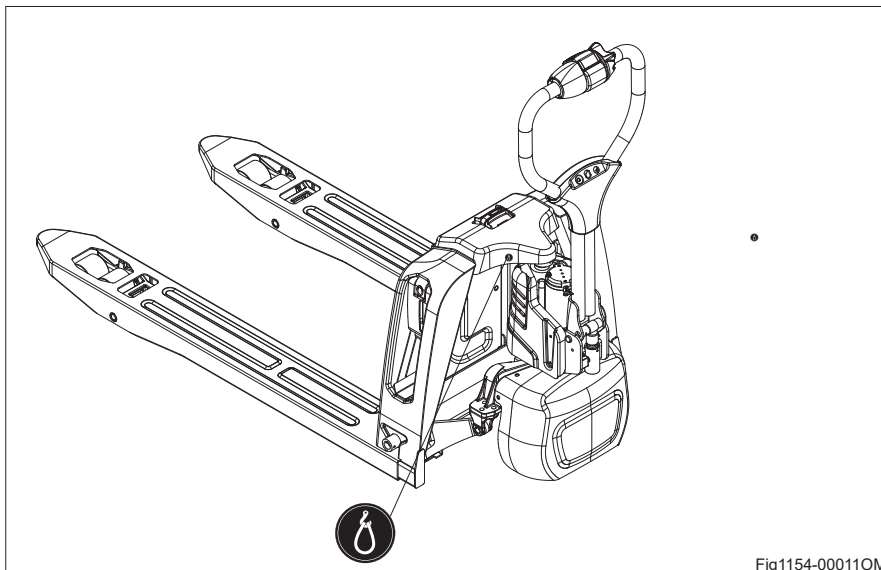

# B

## Operation

### 1.1 Utilization safety specification



Fig0000-001200M

- Average ambient temperature for continuous duty:  $+ 25^{\circ}\text{C}$  ;
  - Maximum ambient temperature, short term (up to 1h):  $+ 40^{\circ}\text{C}$  ;
  - Lowest ambient temperature for trucks intended for use in normal indoor conditions:  $+ 5^{\circ}\text{C}$  ;  
Lowest ambient temperature for trucks intended for use in normal outdoor conditions:  $- 20^{\circ}\text{C}$  ;
- Don't use the truck in rainwater.
- Don't use the truck in non-position.

#### **i** NOTE

*Special equipment and authorisation are required if the truck is to be constantly used in conditions of extreme temperature or air humidity fluctuations. We recommend with special measures for the truck or buy the truck for cold store. If in doubt, contact the manufacturer's customer service department.*

#### **i** NOTE

*Lithium battery charging temperature range:  $5\sim 40^{\circ}\text{C}$  ,  $0^{\circ}\text{C}$  below the low-temperature environment under the conditions of large-scale charging will cause damage to the battery; Discharge temperature range:  $-20^{\circ}\text{C} \sim 55^{\circ}\text{C}$  , low temperature ( $-20^{\circ}\text{C} \sim 0^{\circ}\text{C}$  ) discharge capacity than at room temperature may be reduced compared to normal, it is normal; battery can be  $40^{\circ}\text{C} \sim 55^{\circ}\text{C}$  Ambient temperature, but the battery ambient temperature is too high, especially in the long-term high temperature battery environment, will accelerate the aging of the battery material, shorten the battery life, it is not recommended for long-term use at this temperature. Ambient temperature exceeding the above range of charge and discharge temperature may adversely affect the battery performance or damage, may greatly shorten the battery life, it should be avoided at the above temperature.*





- Avoid the use of the truck by non-working personnel.
- Don't ride on the truck.
- Don't carry or lift people by the truck.



Don't use the truck on slippery road surfaces.  
(such as road surfaces with oil stain or residual snow or those frozen ones )



Don't carry goods on steep slope to prevent goods from sliding off.

Fig0000-00121OM

## **i** NOTE

*Conditions of operation road surface: the truck should run on solid, flat, level and paved road surfaces (including both running and lifting).*



Don't leave the truck before it is parked as regulated.



- Don't use the truck when any non-working personnel is in the dangerous area.
- Don't be distracted when using the truck.
- Don't be distracted when using the truck.



Don't place any part of your body in any moving part of the truck to avoid being clamped.

Fig0000-00122OM



## WARNING

- Fire extinguisher shall be equipped at the work site. Users can choose truck equipped with fire extinguisher. Driver and manger should be familiar with the fire extinguisher position and application method.
- Use tray when carrying small items, do not place on the fork directly.
- After power off, brake works and the truck can not be towed(dragged).
- Do wash the inner of the truck, do not place the truck outdoors and exposed to the rain.
- Before dismantle or repair the truck, lift the battery out of the truck firstly.

### 1.1.1 EN standards



**Continuous sound level:** 74 dB(A)  
according to EN 12053 as stipulated in ISO 4871

The continuous sound level is a value averaged according to standard regulations, taking the sound pressure level into account when driving, lifting and idling. The sound pressure level is measured at the ear.

### Electromagnetic compatibility (EMC)

The manufacturer confirms compliance with the limit values for electromagnetic emission and interference immunity as well as testing of static electricity discharge according to EN 12895 and the references to other standards contained therein.

Electrical or electronic components and their arrangement may only be modified after written approval by the manufacturer has been obtained.

### 1.1.2 Conditions for application



#### Working condition requirements:

- The truck's maximum operation altitude is up to 2000m.
- Trucks can only be operated in adequately illuminated working areas to avoid injuries. In case of insufficient light, an additional lighting equipment is needed to ensure that the driver can see properly.

If you must travel on an incline, the gradients should be below A% at full load, or below B% without a load.(For the value of A and B, refer to the Gradability in technical data)

### 1.1.3 Stability



**Stability is guaranteed if your truck is used properly in accordance with its intended purpose. Common reasons for a loss of truck stability include:**

- Emergency stops or sharp turns
- Driving with a raised load or a load handling device
- Turning the vehicle around on or driving across a slope
- Driving up or down a slope with the load pointing downhill
- Driving with a wide load
- Carrying a swinging load
- Driving near the edge of a ramp or up steps
- Tilting the mast forward while carrying a raised load
- Driving on uneven surfaces
- Overloading the truck
- Carrying bulky loads in strong winds
- When carrying liquid, its centre of mass inside the container may shift due to inertial force (such as when pulling away, braking or turning)

## 1.2 Display and Manipulation

### 1.2.1 Truck overview

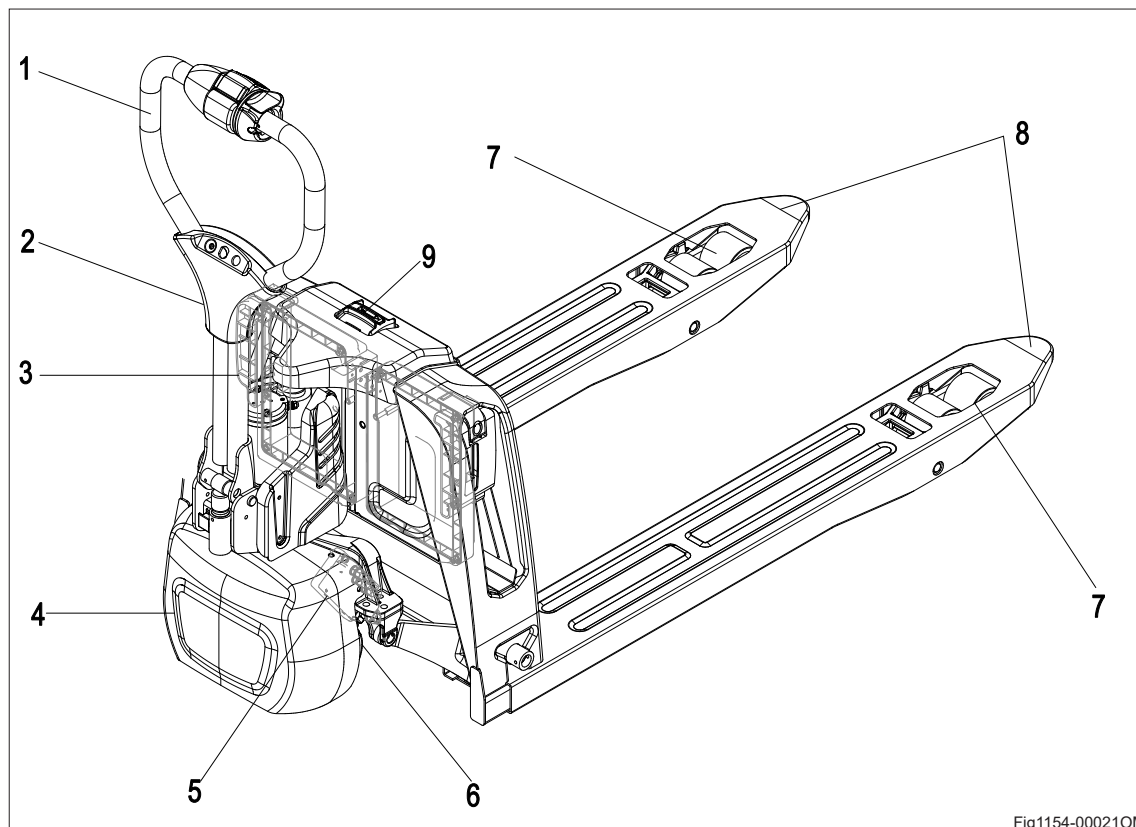

Fig1154-00021OM

1	Control handle	8	Fork arms
2	Control handle cover	9	Supply plug and display instrument
3	Lithium-ion battery		
4	Driving hood		
5	Controller		
6	Driving wheel		
7	Load wheels		





## 1.2.2 Control handle

11	Key switch	Connect and interrupt control current.
12	Fault indicating lamp	Shows the error state of the truck( see the chapter error code)
13	Horn button	Send out sound warning signals.
14	Lift button	Raises the load device. When the battery is consumed about 85%, lifting function will be locked.
15	Lower button	Lowers the load device.
16	Drive switch	Controls travel direction and speed
17	Creep speed switch	If the control lever is set to the brake zone(B), and press creep speed switch and drive switch at the same time, then the vehicle will move at a low speed.
18	Emergency reverse switch	By pressing this switch, the vehicle starts to travel in the opposite direction.

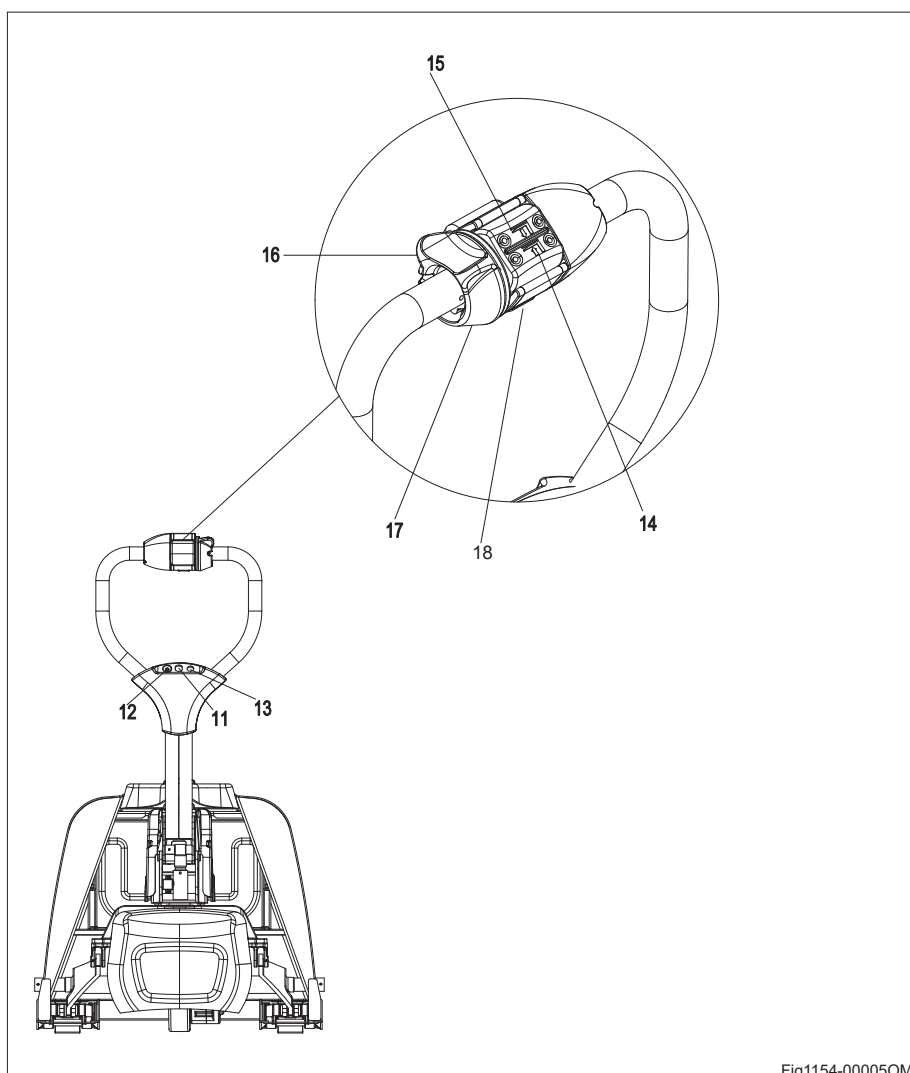

Fig1154-00005OM

### 1.2.3 Key switch



#### Key switch

##### Connect and interrupt control current.

- When the key rotates to gear "OFF", the control current of the truck will be interrupted;
- When the key rotates to gear "ON", the control current of the truck will be connected.

#### **i** NOTE

*Pulling out the key switch of a forklift before leaving can prevent the forklift from starting accidentally.*

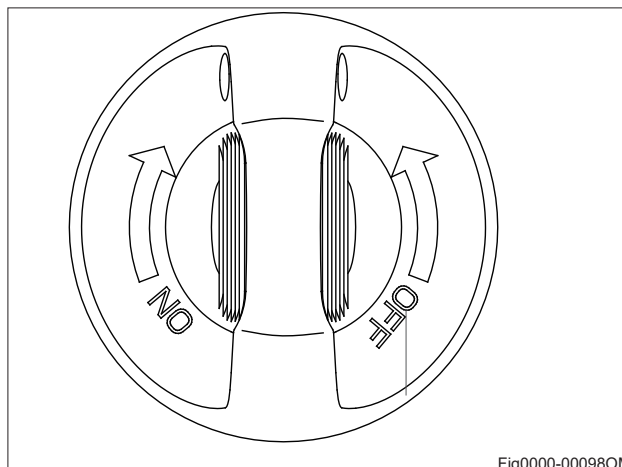

Fig0000-00098OM

### 1.2.4 Display instrument



When the truck is started, the four light indicator will light up. When the only residual light indicator (4) is flashing, it means that the truck capacity is low and it should be charged immediately. Otherwise the truck will be power off.

#### **i** NOTE

*It is normal that the light indicator will still be on when the key switch is turned off and the supply plug is not pulled out.*

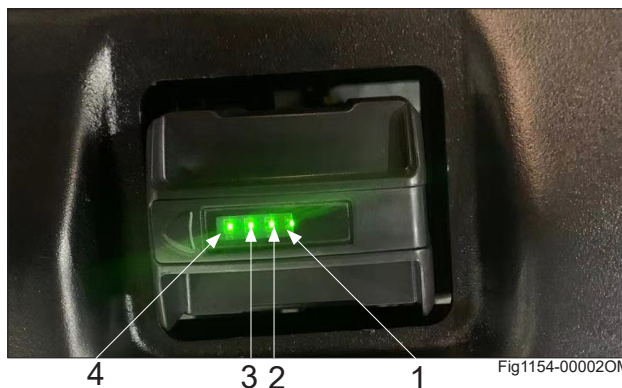

Fig1154-00002OM

#### **i** NOTE

##### Low Voltage Protection

*The car has low voltage protection function.*

*When the battery power of forklift truck is 7%-15%. At this time, the truck can not lift goods, but it can run normally. When the battery power is less than 7%. At this time, the truck can not be lifted and the driving speed becomes slower.*

## 1.3 Truck use and operation

### 1.3.1 Preparation for use



#### **WARNING**

The following are inspection and preparation operations that must be implemented before the truck is put into daily use.

Table 1. Table of daily inspections by operators

### Operator's Daily Checklist

Date \_\_\_\_\_ Operator \_\_\_\_\_  
 Truck No. \_\_\_\_\_ No. \_\_\_\_\_  
 Department \_\_\_\_\_  
 Runtime \_\_\_\_\_  
 Meter Reading \_\_\_\_\_

Daily Check Items	O.K.(√)	Remark
Check for Fluid Leakage		
Check for scratches, deformation or cracks.		
Check Decal Condition		
Check the smooth movement of the wheels.		
Check the function of the emergency brake by activating the supply plug.		
Check the tiller arm- switch braking function		
Check the lifting and lowering functions by operating the buttons.		
Check if all bolts and nuts are tightened firmly.		
Check the vertical creep of the truck.		
Check the lithium-ion installation, making sure not to damage the battery cables.		
Recharge the lithium-ion battery		

**Table 1:** Table of Daily Inspections by Operators is only a sample table for the daily inspections of operators, and it can be adjusted according to specific requirements.



## WARNING

*The truck should be regularly maintained by qualified maintenance engineers or technicians that have passed the training of and also been authorized by the manufacturer.*

### 1.3.2 Comissioning



*The truck must only be operated on battery current!*

*To prepare the truck for operation after delivery or transportation, the following operations must be performed:*

*Check the equipment for completeness.*

*If necessary, install the battery. Make sure that the battery cable is not damaged.*

- Charge the battery.
- Check for Fluid Leakage.
- Check the brake function.
- Check the lifting and lowering function.
- Check the driving function.
- Check the steering function.
- The truck can now be started, see 1.3.3 Truck starting



## WARNING

*The truck must only be operated with a lithium-ion battery.*



## NOTE

*If the truck is delivered in multiple parts, setup and commissioning must only be performed by trained, authorised personnel.*

### Wheel flattening

If the truck has been parked for a long period, the wheel surfaces may tend to flatten. This flattening has a negative effect on the safety and stability of the truck. Once the truck has covered a certain distance, the flattening will disappear.



### 1.3.3 Truck starting



Carry out check before operation and make sure each function and state is normal(see section 1.3.1 Preparation for use).

Before start, press the horn button (3) and make sure no people around.

1. Engaged the supply plug (1);
2. Open the key switch (2) to start the truck.

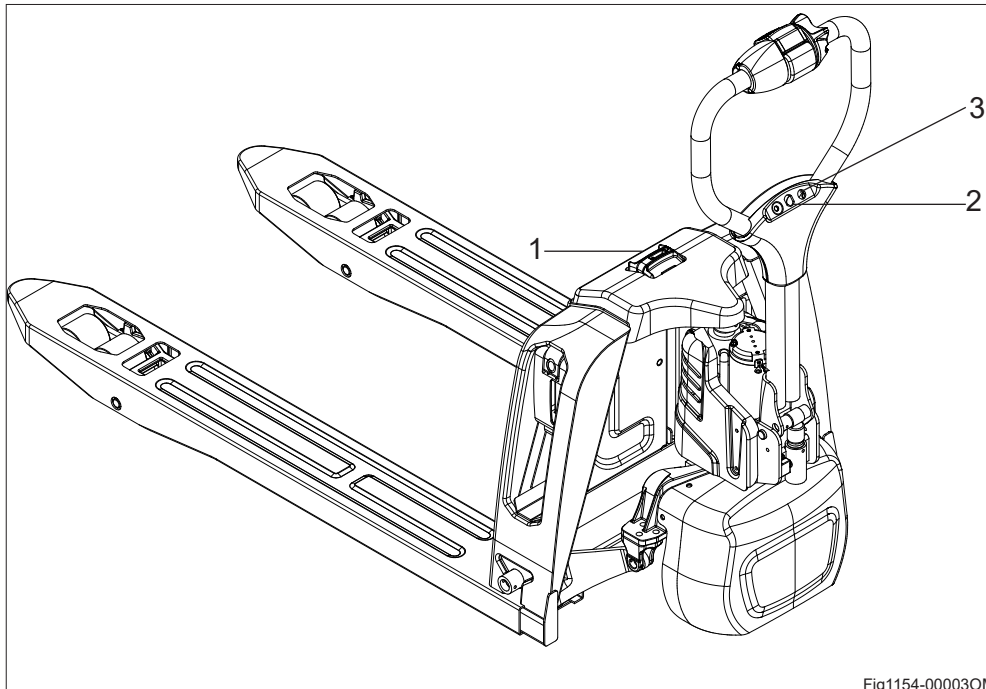

Fig1154-00003OM

### 1.3.4 Running, steering and braking



#### ➤ Running

Set the control lever to the running area (M) ,Set the drive switch (1) to the required direction (Forward or Backward). Control the travel speed with the drive switch(1) (the larger the turning angle, the faster corresponding speed)

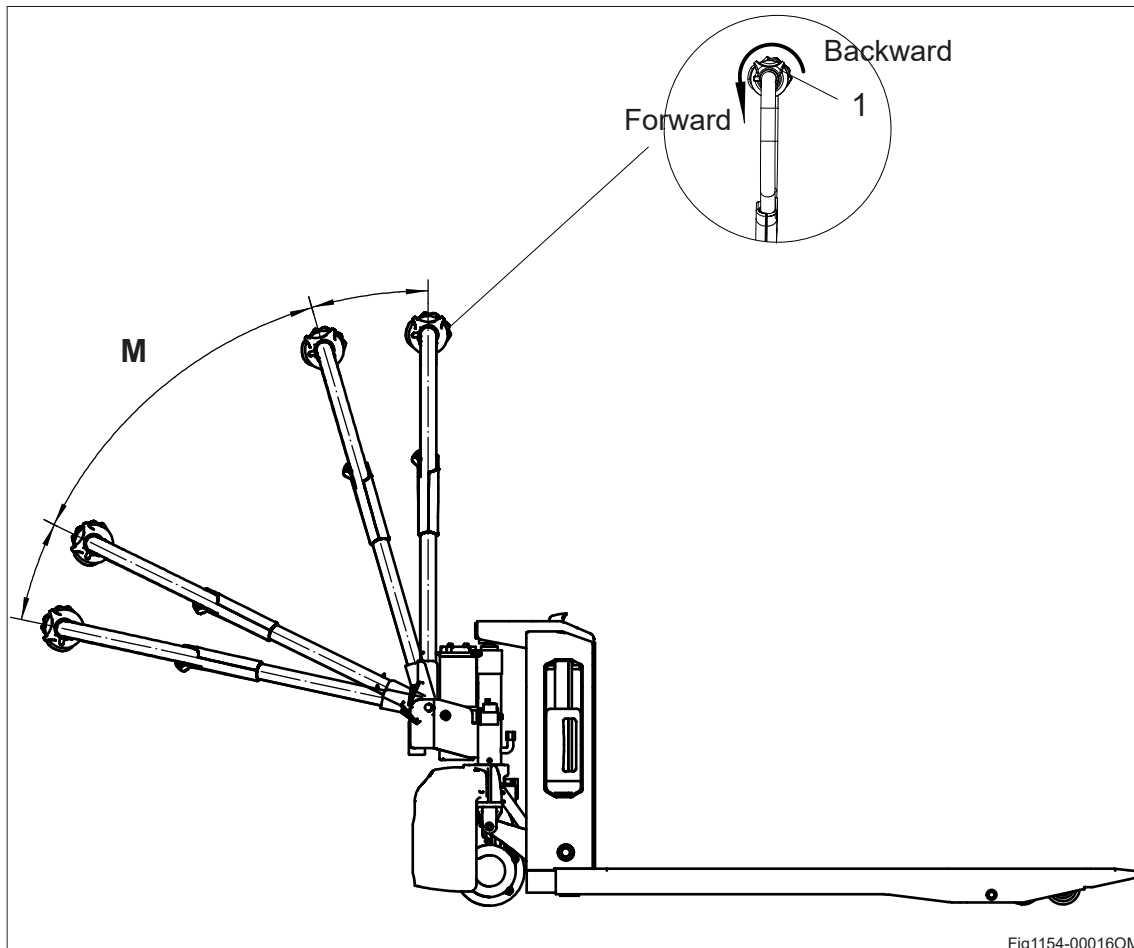

#### **i** NOTE

*When using the truck on a ramp or a uneven road, please lift the forks of the truck to prevent its bottom from colliding with the road surface.*

Driver should walk in front of the truck and keep at the side front of the truck when travelling. One hand holds the handle, and operates travel switch with thumb. Always watch moving direction and guide the truck. Or hold the handle with both hands and push the truck go forward.

## CAUTION

- Operator must wear protective boots.
- When enter narrow area as lift, first get fork go.
- Travel according to regulated route. Keep road clean and no slipping.

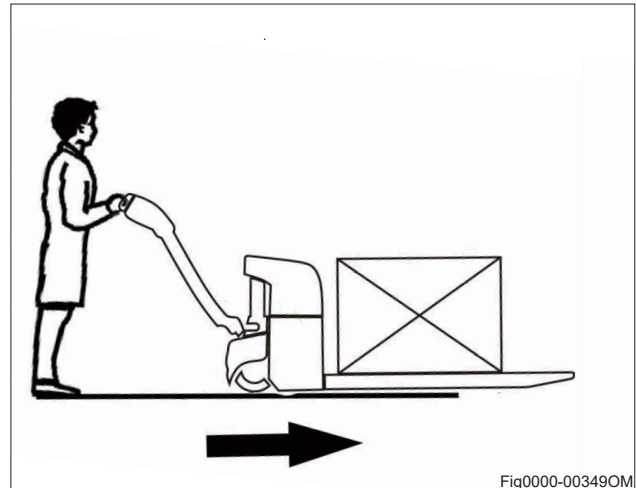
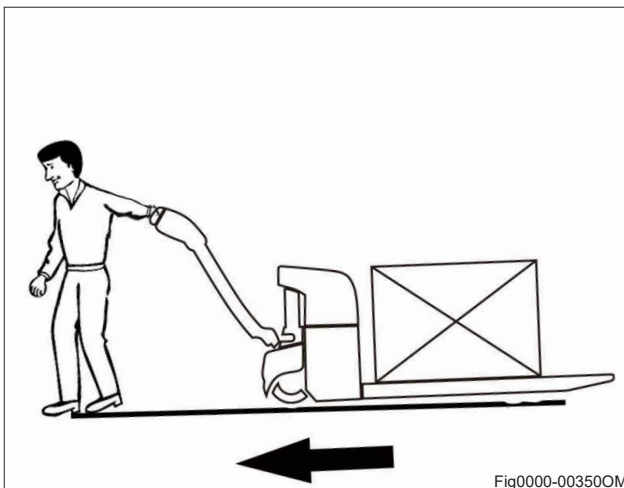

## ➤ Slow travel

When you apply the slow travel speed button and drive switch in the brake zone (B), the truck travels at reduced speed and acceleration.

### Procedure:

- Press the slow travel speed button (1) and drive switch (2) in the brake zone (B).
- The truck can be operated with a control lever (3) (e.g. in congested areas/travel seat).
- Set the drive switch (2) to the required direction (forward or backward).
- The truck travels at slow speed.

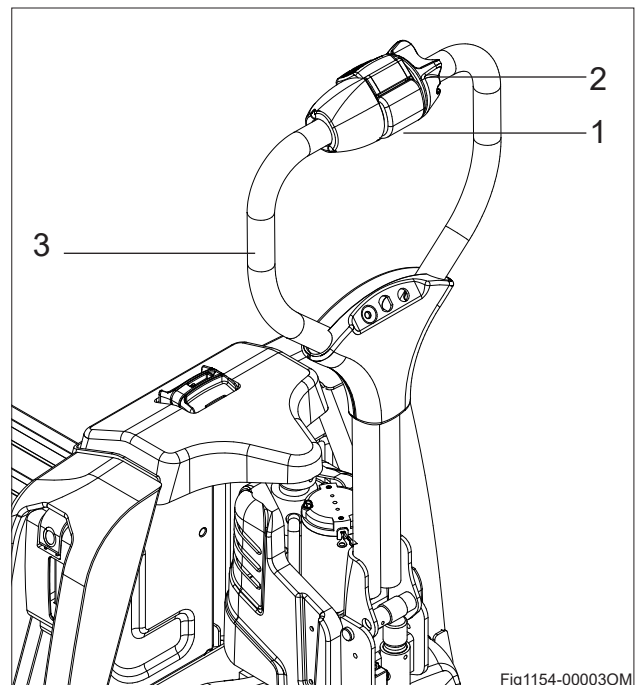

## ➤ Steering

Move the control hand to the left or right.

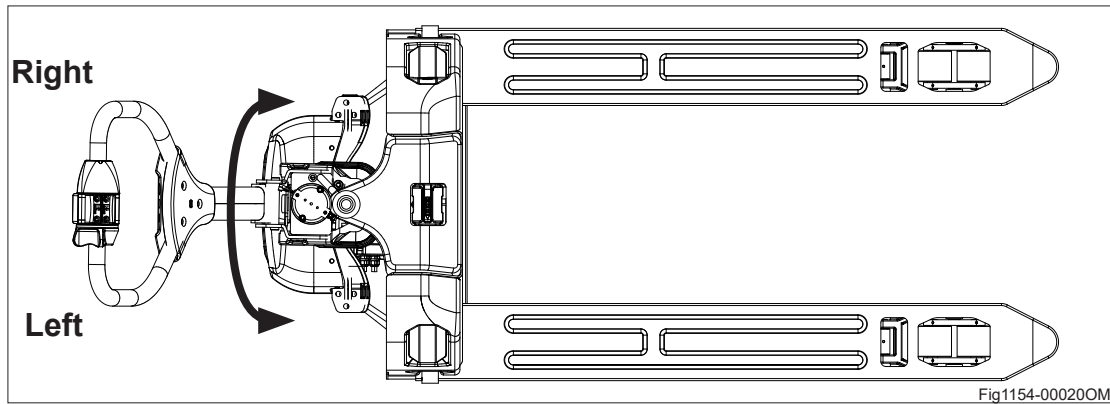

## 3.Braking

### ➤ Mechanical operating brake

The truck is braked when the operating handle is released.  
The mechanical brake engages when the tiller is positioned in (B) area.



### CAUTION

*If the control handle moves slowly into the brake position, identify the cause and rectify the fault. If necessary, replace the spring!*

### ➤ Regenerative braking

Release the drive switch. The drive switch will automatically return to the initial position and the vehicle will begin to enter the regenerative braking state. When it decelerates to <1 km/h, the electromagnetic brake will bring the motor to a stop.

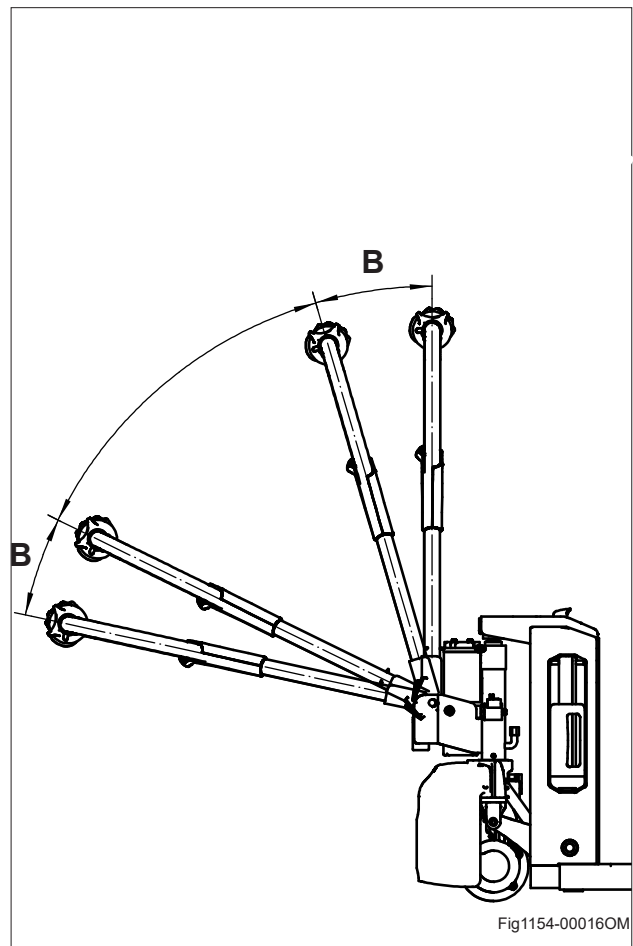

➤ **Reverse braking**

Braking can be accomplished by changing the direction of travel.

Press the reverse switch in the opposite direction until the truck comes to a stop, then release the drive switch.



**CAUTION**

*Open the drive switch; if the drive switch cannot quickly return to the initial position or resets very slowly, identify the cause and rectify the fault.*

➤ **Parking brake**

The mechanical brake applies automatically when the truck comes to rest.

➤ **Supply plug**

Pull out the supply plug, and then all the electrically propelled functions will be interrupted.

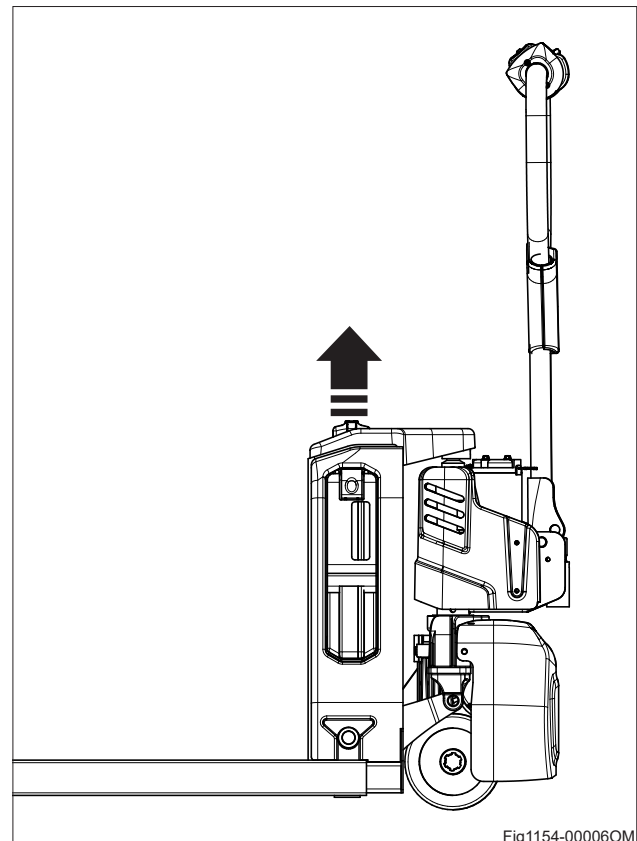



### 1.3.5 Goods picking

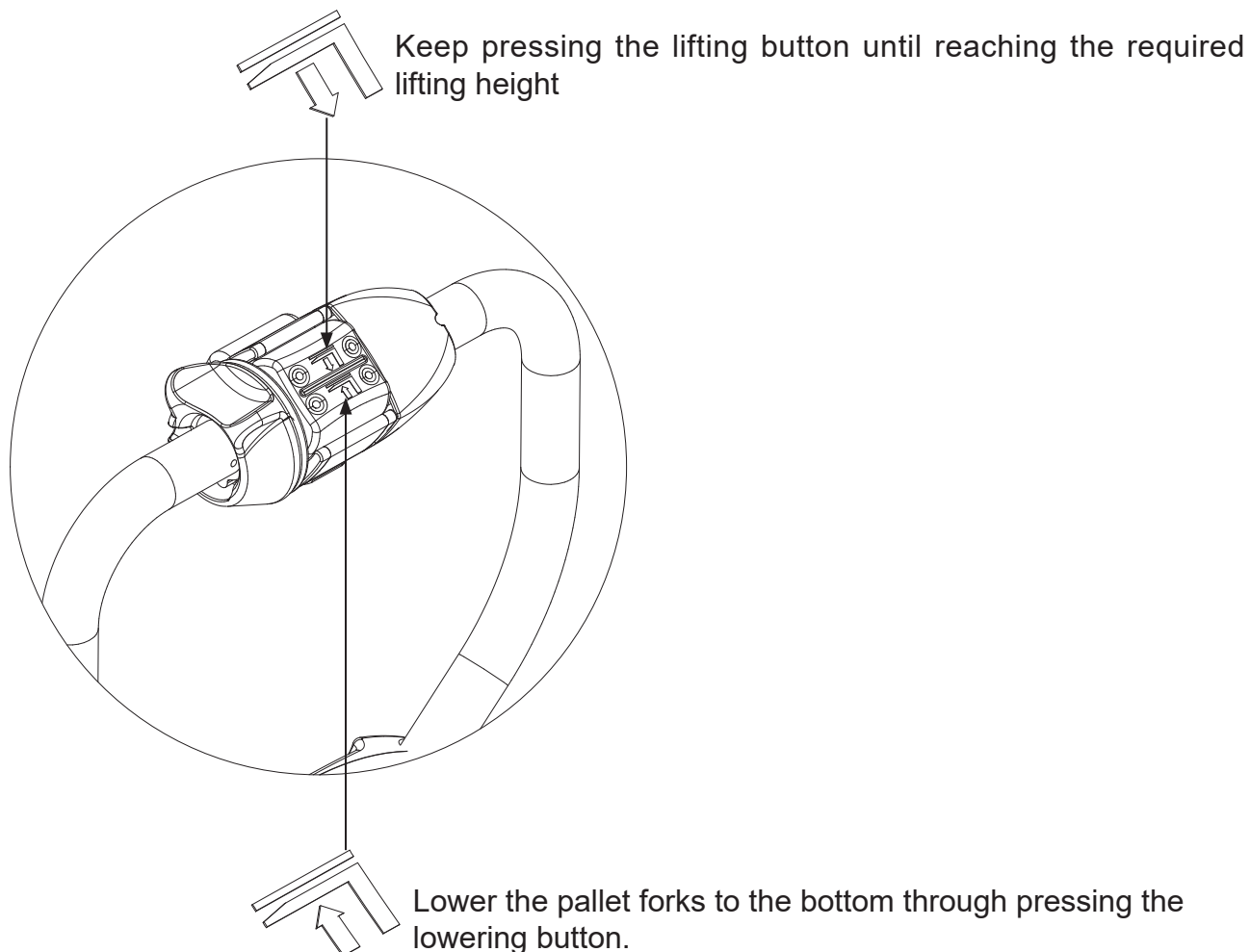

Fig1154-00012OM



#### **WARNING**

*Goods failing to be arranged and fixed may result in accidents.*



#### **NOTE**

*To avoid shortening the service life of the oil cylinder, try not to lift the forks to the highest state for lifting.*

### 1.3.6 Parking the truck securely



Drive the truck to safe area or appointed area.

Lower the forks to the bottom;

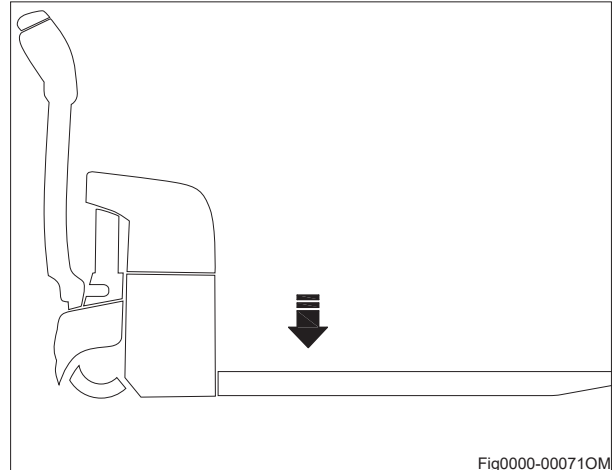

Turn off the key switch(1) ;

Pull out the supply plug (2) ;

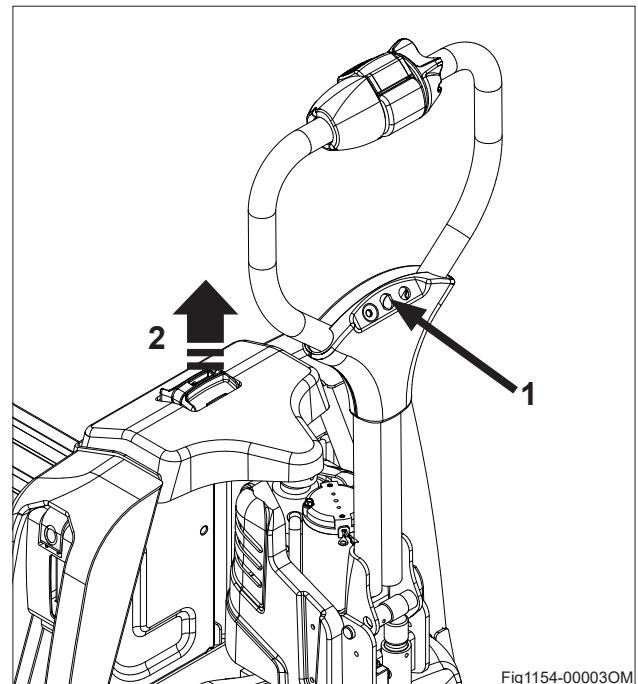

#### **WARNING**

- Should it be necessary for operators to leave the truck, even for just a moment, the truck should also be well parked as specified.
- The trucks are not allowed to park on the slopes.
- The forks must be lowered to the bottom.

### 1.3.7 Drive directions



The drive directions of the truck are forward (1) and reverse (2).

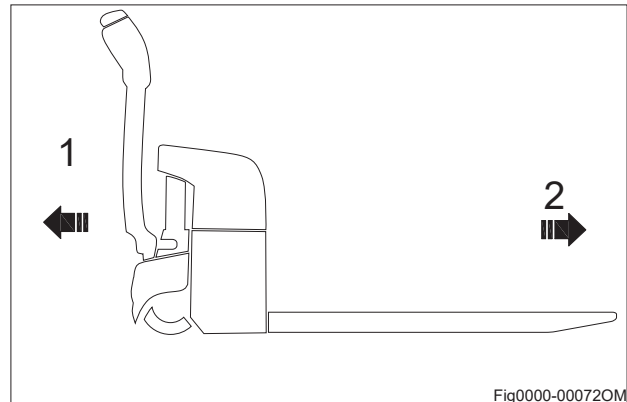

Fig0000-00072OM

### 1.3.8 Loading



- Approach the load carefully.
- Adjust the height of the forks until they can be easily inserted into the pallet.
- Insert the forks under the load.
- If the load is shorter than the forks, position the forks so that the front of the load overhangs them by a few centimeters, to avoid interference with the load immediately ahead.
- Raise the load a few centimeters above its support.
- Back the truck away from the stack or any neighboring loads, gently and in a straight line.

#### ➤ Transporting loads

Always carry loads in the forward direction of travel (R) in order to have the best visibility.

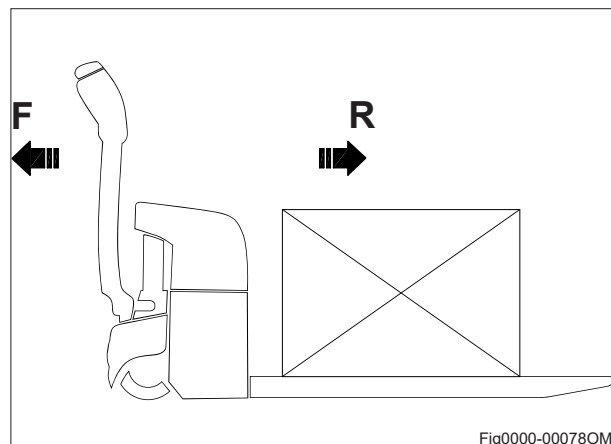

Fig0000-00078OM

When carrying a load on a slope, always ascend or descend with the load uphill. Never drive sideways across a slope or perform a U-turn.

Reverse travel (F) is to be used solely for unloading. Since visibility is reduced when travelling in this direction, drive only at very slow speed.



### ➤ Unloading

Carefully drive the truck to the desired location.  
Carefully drive the truck to the unloading area.  
Lower the load until the fork arms are free from the pallet.  
Back the truck away in a straight line.  
Raise the forks to proper height.



### CAUTION

*If the field of vision is poor, ask a guide for assistance.*

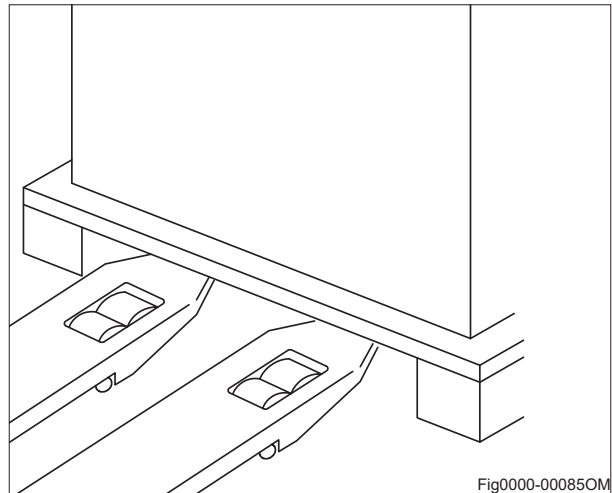

## 1.3.9 Using the truck on a slope



### NOTE

*Incorrect use of the truck on slopes places stress on the traction motor, brakes and battery.*

Be particularly careful near slopes:  
Never attempt a slope with a gradient greater than that specified in the truck's data sheet. Make sure that the ground is dry with a non-slip surface and that the route is clear.

### ➤ Ascending slopes

Always ascend slopes travelling in the reverse direction, with the load facing uphill. Without a load, it is recommended to ascend slopes forwards.

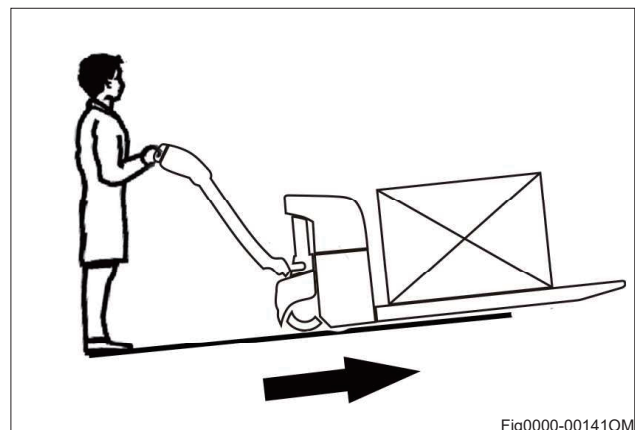

### ➤ Descending slopes

Travel down slopes must always be forwards, with the load uphill. Without a load, it is recommended to descend slopes forwards. In all cases, travel at a very low speed and brake very gradually.

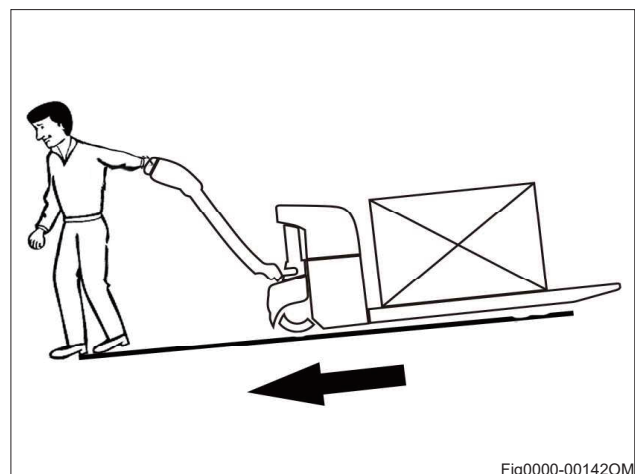



## **DANGER**

*Risk to life and/or risk of major equipment damage.*

*Never park the truck on a slope.*

*Never make a U-turn or take shortcuts on a slope. On a slope, the operator must drive very slowly.*

### ➤ **Starting on a slope**

If you have to stop and then start on slope, proceed as follows:

- Stop on the slope by pressing the accelerator in the opposite direction until the machine comes to a standstill.
- Return the accelerator to the neutral position, then release the accelerator control button to apply the parking brake.
- To restart, press the accelerator button for the desired direction.
- The truck will move.



## **NOTE**

*Incorrect use of the truck on slopes places stress on the traction motor, brakes and battery.*

### 1.3.10 Truck transport



Correctly fix the truck to avoid move when using truck or trailer.

Procedure:

- Park the truck securely.
- Sling the tensioning belt (1) around the truck and attach it to the fastening rings of the transporting vehicle.
- Use wedges to prevent the truck from moving.
- Tighten the tensioning belt (1) with the tensioner.



#### **WARNING**

- *The truck or trailer must have fastening rings.*
- *Use wedges to prevent the truck.*
- *Only use tension belt or fastening belt of good nominal strength.*

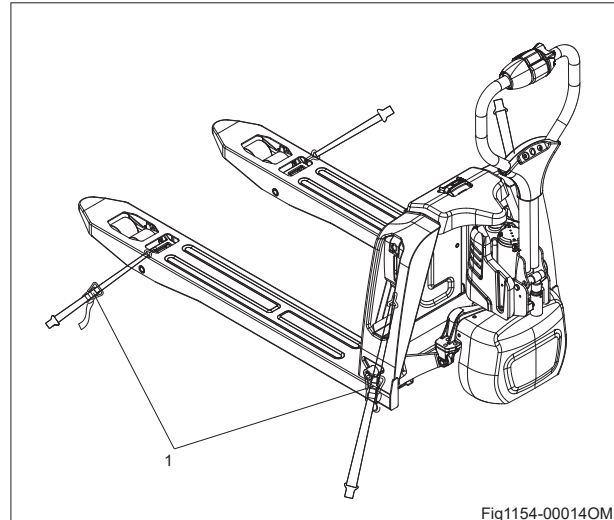

The pallet truck is designed for short-distance material handling only and is inappropriate for long-distance transportation. If needed, the truck must be transported by using lifting device or platform to place it on truck or trailer. Before operation, fix the pallet truck firmly on the transport vehicle with belt, and block the wheel to avoid relative motion during transportation.

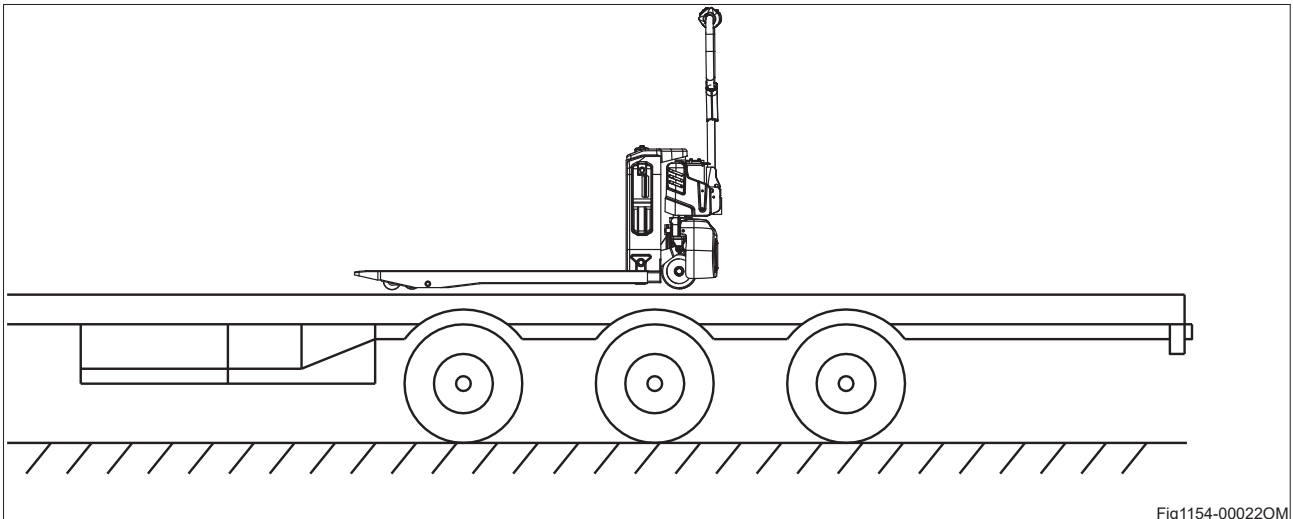

### 1.3.11 How to remove a broken truck



It's not allowed to tow the forklift truck on the ground directly when the truck is broken down or damaged since the brake of the truck is closed under normal circumstances. Appropriate vehicles should be used to remove the broken trucks.

#### **i** NOTE

*Only use haulage equipment with sufficient load capacity.*

- *The load weight includes the net weight of the truck (including battery weight) and the wooden pallet.*
- *The pallet or wooden box should be large and strong enough to withstand the weight of the truck.*
- *Pay attention to the fork blades when lifting the truck onto the pallet, to prevent injuries caused by the forks.*

*Follow the prescribed steps and park the vehicle correctly.*

*Make sure the forks are aligned with the pallet, move slowly and stop after inserting the forks as far into the pallet as possible.*

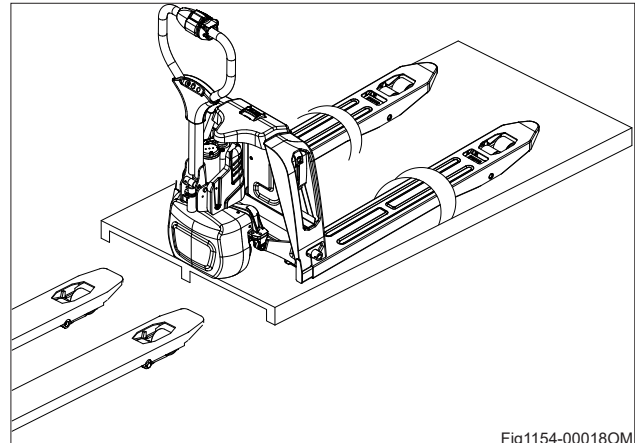

#### **CAUTION**

*Operate on open, level ground and pay attention to ground conditions when lifting and lowering the pallet to prevent the truck from tipping.*

*When transporting the truck, make sure it is fully secured and take precautionary measures against bad weather.*



### 1.3.12 Operating the truck without its own drive system

If the truck has to be moved after a failure has rendered it immobile, proceed as follows:

- Pull out the supply plug.
- Set the key switch "OFF" and remove the key. Prevent the truck from rolling away.
- Remove the cover.
- Screw in two screws(1), M4\*35mm until the truck can be moved (no braking action).
- After setting down the truck at the destination, unscrew two screws(1).
- Braking action is restored.



#### **WARNING**

*This operating mode is not permitted when negotiating inclines and gradients.*

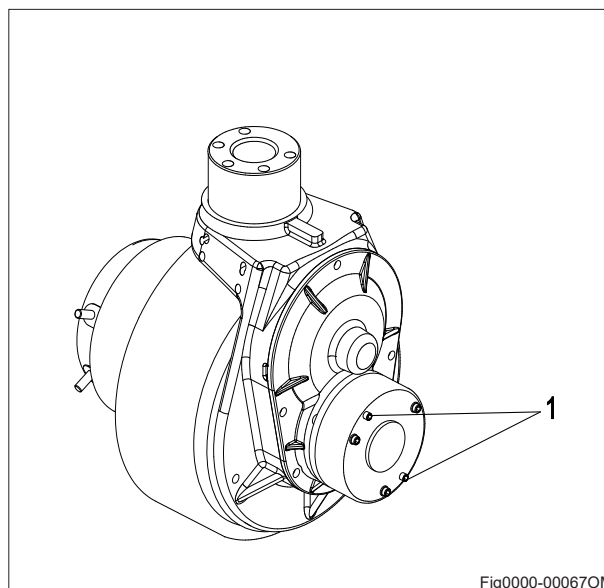

# C

## Battery use and maintenance

### 1.1 Battery charging

#### 1.1.1 Precautions

- The truck must be parked within a shady and ventilated room;
- Do not place metal objects on the battery;
- All the cable and plug connection parts should be inspected in terms of obvious damages before charging;
- The supply plugs on the battery cells must always be dry and clean.
- The surface of the battery must be clear to ensure sufficient.
- The charging connector must be dry and clean when used.
- Charging in non-charging area is prohibited;
- No modification of vehicles;
- Do not use irregular charging sockets;
- The net height of the charging area shall be higher than 5m, and the safe distance from other areas shall be greater than 5m.

#### 1.1.2 Charging the battery with external charger

##### Charging Procedure:

- Park the truck securely;
- Pull up the supply plug and remove the lithium-ion battery from one side;
- Visual Inspection the external charger;
- If undamaged, Insert the charger charging plug into the battery plug;
- Insert the charger power plug into a suitable power outlet.

##### **i** NOTE

*The charge indicator lights up, the battery is charging.*

*LED charging indicator: Red charging*

*LED charging indicator: Green charged*



##### **WARNING**

*Charger 24V/4A maximum input power 300W.*

*Please strictly implement the above data to prevent equipment damage and accidental risks such as fire.*

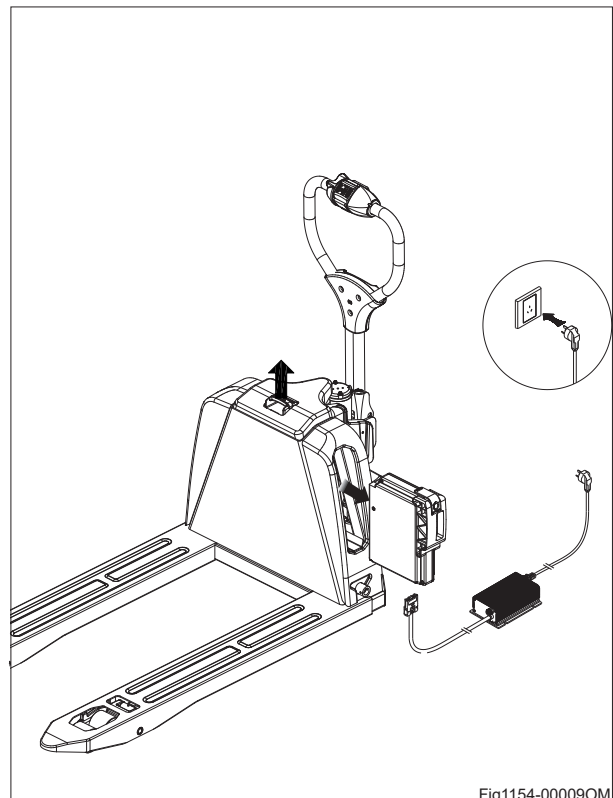

The battery is fully charged after  
5.0 hours of charging at 100 ~ 240V AC;

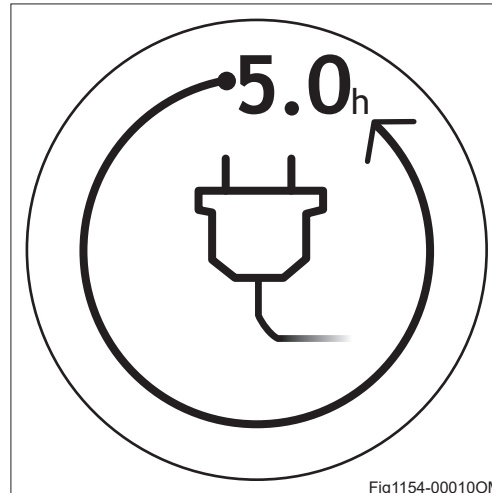

Insert the battery into the battery compartment  
of the truck.

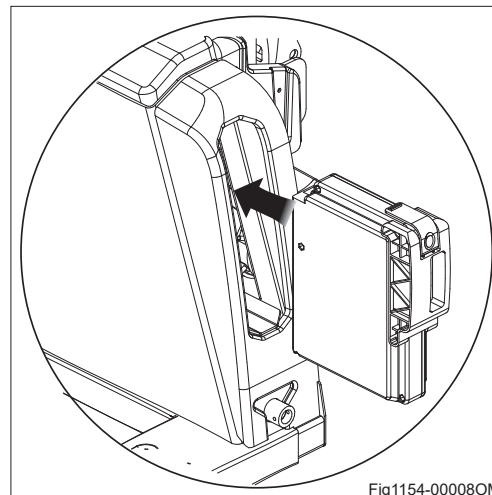

The battery can be operated continuously for 2.0  
hours in a fully charged state.

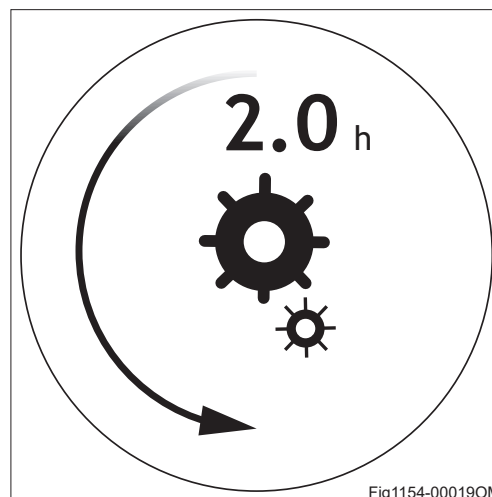

### 1.1.3 Battery type & dimensions&Charging time

Battery types & dimensions are as follows:

Tuck type	Voltage/ Rated capacity	Dimensions	Charger	Charging time
F4	24V/20Ah	290*238*76	4A	5h

## 1.2 Battery removal and installation

Park the truck securely as described chapter B section 1.3.6 and turn off the power before removal and installation of the battery.

### Battery removal and installation steps:

Pull out the supply plug(1) ;  
Hold the battery handle and remove the  
Lithium-ion battery from one side;



### WARNING

*Before removing the battery, make sure the vehicle is completely powered off.*

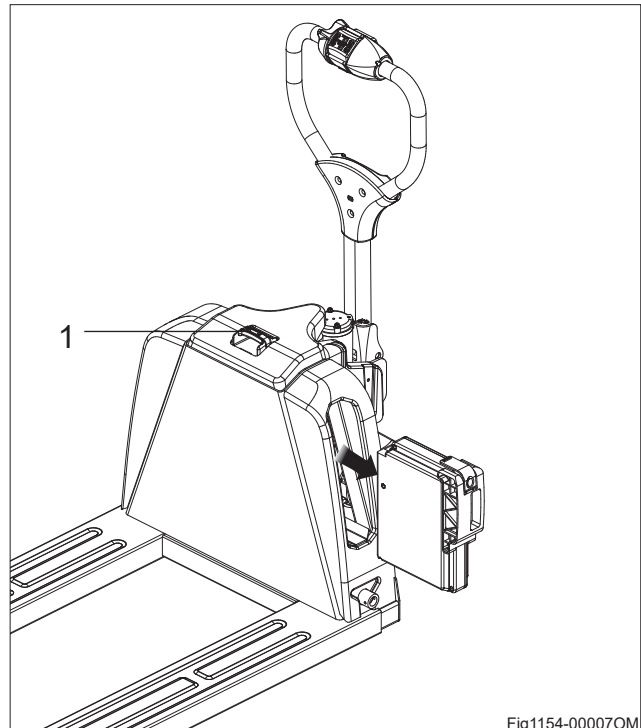

Fig1154-00007OM



# D

## Maintenance

### 1.1 Truck maintenance

Only through regularly implementing truck maintenance work can the sustainable and reliable use of the forklift be ensured.

Only those receiving professional training and approved as qualified can be competent in various equipment care maintenance operations. If you intend to independently implement maintenance, you are recommended to have your maintenance personnel receive on-site training from the service representative of the equipment supplier.

#### ➤ **Safety announcement:**

- Tyre replacement: please implement tire replacement using the tires designated by the manufacturer, as unqualified tires may influence the properties and stability of the products.
- It is improper to clean the truck using inflammable liquid.
- Ensure that the power supply has been completely disconnected before actual maintenance operation.

#### ➤ **Decommissioning the industrial truck:**

- If required to be parked for over one month, the truck must be placed in a dry and frost-free environment.
- Clean the truck carefully.
- Coat any unpainted metal parts with a thin layer of oil or grease.
- In case that the truck is out of use for a long time, the storage battery should better be taken out.
- Recharge the lithium-ion battery every 2 months. Please observe the above instructions.
- Raise and chock the truck: the wheels must not touch the ground in order to prevent irreversible deformation of the tyres.



#### **WARNING**

*Discharge can damage the battery*

*If the battery is not used for a long period of time, it can become damaged through discharge.*

- *Before a long period of inactivity, the battery must be fully charged.*
- *To ensure a long battery life, we recommend charging the battery every 2 months when it is not being used.*

#### ➤ **Restoring the truck to operation**

- Thoroughly clean the truck.
- Clean the battery. Grease the pole screws using pole grease and reconnect the battery.
- Recharge the battery.
- Check if the hydraulic oil contains condensed water and change if necessary.
- Follow the daily checklist.

## Safety tests to be performed at intervals and after unusual incidents

The truck must be inspected at least annually (refer to national regulations) or after any unusual event by a qualified inspector. The manufacturer offers a safety inspection service which is performed by personnel specifically trained for this purpose.

A complete test must be carried out on the technical condition of the truck with regard to safety. The truck must also be examined thoroughly for damage.

The operating company is responsible for ensuring that faults are rectified immediately.

## Spare parts:

Only original spare parts have been certified by our quality assurance department. To ensure safe and reliable operation of the Pallet truck, use only the manufacturer's spare parts. Used parts, oils and fuels must be disposed of in accordance with the relevant environmental protection regulations. For oil changes, contact the manufacturer's specialist department.

## Tyre replacement

Any repairs or maintenance to the truck must be performed only by trained and authorized technicians. Remove and install the tyres see the service manual.

## Troubleshooting

If the fault cannot be rectified after carrying out the remedial procedure, notify the Manufacturer's service department, as any further troubleshooting can only be performed by specially trained and qualified service personnel.

Fault	Probable Cause	Action
Truck does not start.	<ul style="list-style-type: none"> <li>–Battery connector not plugged in.</li> <li>–Key switch in “0” position.</li> <li>–Incorrect CanCode code.</li> <li>–Battery charge too low.</li> <li>–Faulty fuse.</li> <li>–Truck in charge mode.</li> </ul>	<ul style="list-style-type: none"> <li>–Check the battery connector and connect if necessary.</li> <li>–Set key switch to “I”.</li> <li>–Check code.</li> <li>–Check battery charge, charge battery if necessary.</li> <li>–Check fuses.</li> <li>–Interrupt charging.</li> </ul>
Load cannot be lifted	<ul style="list-style-type: none"> <li>–Charging capacity below 15% .</li> <li>–Truck not operational.</li> <li>–Hydraulic oil level too low.</li> <li>–Faulty fuse.</li> </ul>	<ul style="list-style-type: none"> <li>–Charging the battery.</li> <li>–Carry out all measures listed under. “Truck does not start”.</li> <li>–Check the hydraulic oil level.</li> <li>–Check fuses.</li> </ul>

## Error Message

Error code	LED BLINKS	Explanation	Possible cause
5	(1,1) □ □	Over Current	The controller detects excessive current, Check whether there is a short circuit in the motor phase line. power off and restart.
9	(1,2) □ □ □	Over Temperature	The controller temperature exceeds 95 ° C, The controller works continuously under a high load, or the ambient temperature is too high, power off and restart.
10	(1,4) □ □ □ □	Under Voltage	The supply voltage is below 17V Power supply battery undervoltage, power off and restart.
6	(1,5) □ □ □ □ □	Over Voltage	The controller detected an overvoltage Check whether the power supply voltage is normal. Power off and restart.
117	(2,2) □ □ □ □	Emergency reverse switch	Emergency reverse switch failure Before power-on, the Emergency reverse switch be engaged, Release the Emergency reverse switch and power on again.
111	(2,3) □ □ □ □ □	MAIN_SHORT	Main relay short circuit
110	(2,4) □ □ □ □ □	MAIN_DRI	Main relay drive circuit failure
116	(3,1) □ □ □ □ □	INTERLOCK	INTERLOCK failure Before power-on, the interlock switch be engaged, and the reset the tiller and powered on again
100	(3,2) □ □ □ □ □	BRAKE	Opening of electromagnetic brake is abnormal. Electromagnetic brake controller circuit failure, replace the controller.
101	(3,2) □ □ □ □ □	BRAKE	The electromagnetic brake shuts down abnormally. Electromagnetic brake wiring is not reliable, or the drive circuit fault, power off restart.
105	(3,3) □ □ □ □ □	PRECHARGE	The Precharge circuit is abnormal
115	(3,5) □ □ □ □ □ □	HPD	HPD failure. Before power-on, the accelerator be activated. Release the accelerator and power on the device again.
11	(4,1) □ □ □ □ □	Current Sensor	The current circuit is abnormal
65	(4,2) □ □ □ □ □	MOS	MOS device damage

Error code	LED BLINKS	Explanation	Possible cause
4, 13	(4,3) □□□□ □□□	EEPROM fault	EEPROM failure or fault.
60	(4,4) □□□□ □□□□	Motor Open	The motor did not connect
69	(4,5) □□□□ □□□□□	TEMP Sensor	The temperature sensor is disconnected or short-circuited.
12	(5,1) □□□□□ □	EMCY STOP	The emergency stop button being pressed was detected.
130	(5,2) □□□□□ □□	SRO	SRO failure. Before power-on, the lift button be pressed. After the fault is show, walking is not affected, but the lifting is prohibited. Release the lift button and power on the device again.

### **i** NOTE

\*LED ON: When there is no failure, the LED indicator is on.

\*LED OFF: The controller is not powered on.

## 1.2 Maintenance table

<b>50-hour/7-Day maintenance</b>	
1	Check the functions of the operation switches and display.
2	Check display equipment, alarm system and safety devices.
3	Check the emergency reverse switch, reverse braking, emergency disconnect switch and regenerative braking.
4	Check tiller steering functions.
5	Check the drive wheel and load wheel for worn or damage.
<b>250-hour/2-month maintenance</b>	
After operating for 250 hours in total, the truck should also be maintained according to the following procedures in addition to the 50-hour maintenance mentioned above	
7	Inspect where there is any damage in the cables and whether the terminals are reliable.
8	Inspect whether there is any screw losing or slipping out.
9	Inspect whether there is any abrasion or damage in the oil pipes.
10	Inspect where is any leakage in the hydraulic oil.
11	Clean and lubricate the contact surface with grease.
<b>500-hour/3-month maintenance</b>	
After operating for 500 hours in total, the truck should also be maintained according to the following procedures in addition to the 250-hour maintenance and 50-hour maintenance mentioned above	
12L	Check that the battery cable connections are tight and grease the battery poles if necessary.
13	Check if the signs are legible and complete
14	Inspect and fasten the controller and other electrical apparatus elements
15	Adding gear oil or grease.
16	Check the oil level in the oil tank.
<b>1000-hour/6-month maintenance</b>	
After operating for 1000 hours in total, the truck should also be maintained according to the following procedures in addition to the 50-hour maintenance, 250-hour maintenance and 500-hour maintenance mentioned above	
17	Inspect whether there is any abnormal sound or disclosure of the gear box.
18	Inspect the abrasion situations of the driving wheel/bearing wheel and please timely replace seriously abraded ones.
19	Inspect whether all the oil pipes, pipelines and joints are reliably connected and whether all the sealing elements are reliable.
20	Inspect the air gap of the electromagnetic brake, and if the air gap is larger than 0.4mm, please replace the friction plates.
21	Check the frame for damage.
22	Inspect where there is any damage in the oil cylinders and whether corresponding installations are reliable
23	Inspect and check the hydraulic filter, replaced if necessary.
24	Check cylinder block and piston for damage and ensure that they are properly sealed and secured.

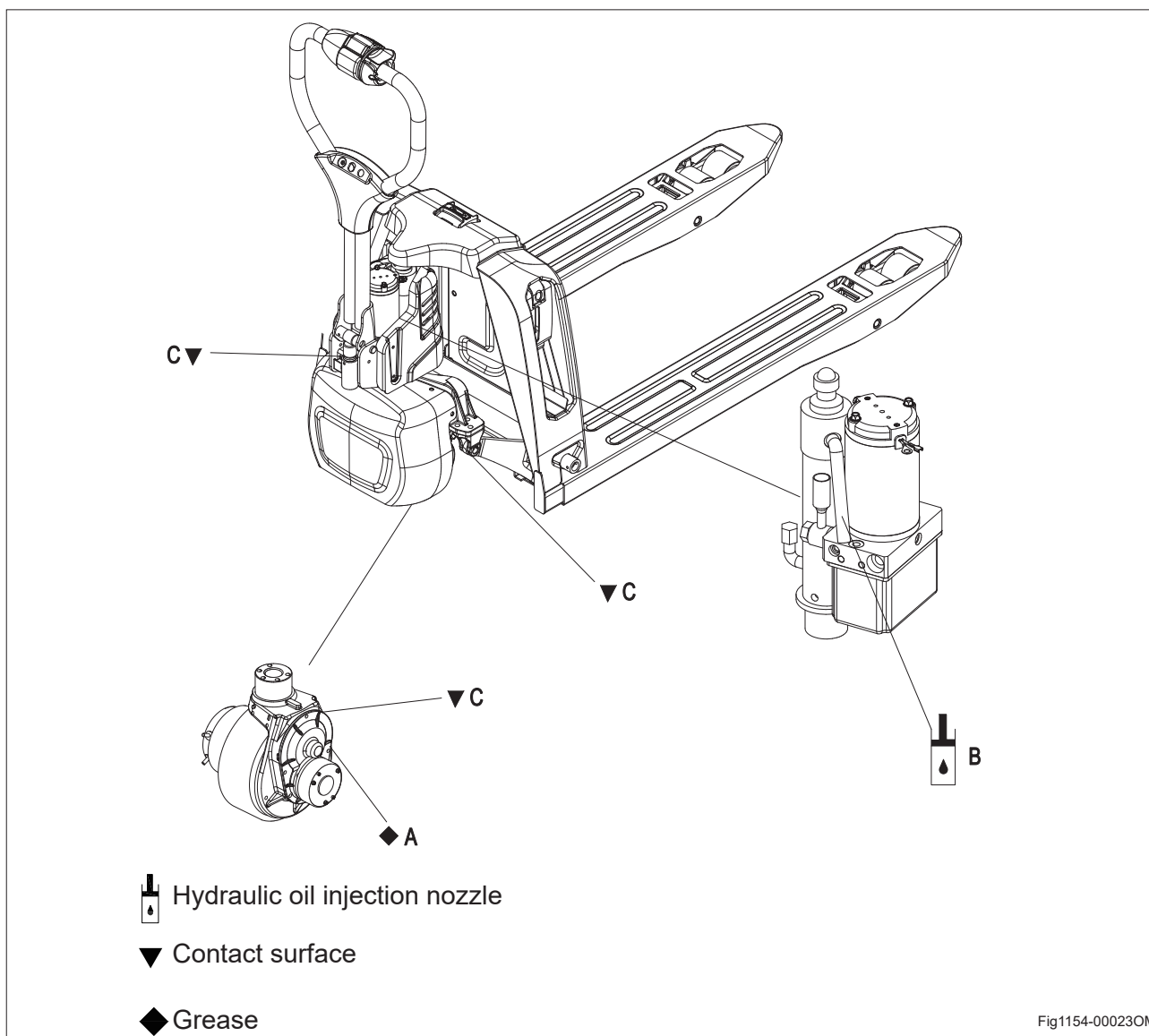

**Table 1 Lubricants**

Code	Type	Specification	Amount	Position
A	Anti-wear hydraulic oil	L-HM32	210-250ml	Hydraulic System
B	Multi-purpose grease	Polylub GA352P	Appropriate amount	Contact Surface
C	Grease 3#(MoS <sub>2</sub> )	-	110 grams	Gearbox

**i NOTE**

Add hydraulic oil till you can't hear explosion sound during lifting any more.

## 1.3 Maintenance Instructions

### 1.3.1 Prepare the truck for maintenance and repairs

All necessary safety measures must be taken to avoid accidents when carrying out maintenance and repairs. The following preparations must be made:

- Park the truck securely (See chapter B section 1.3.6).
- Remove the key to prevent the truck from accidentally starting.
- When working under a raised lift truck, secure it to prevent it from tipping or sliding away.

### 1.3.2 Remove the cover

- Unscrew four screws (1), remove driving cover (2);
- Swivel the control handle 90 degrees, unscrew hydraulic cover (4) of the four screws (5) via the spaces.

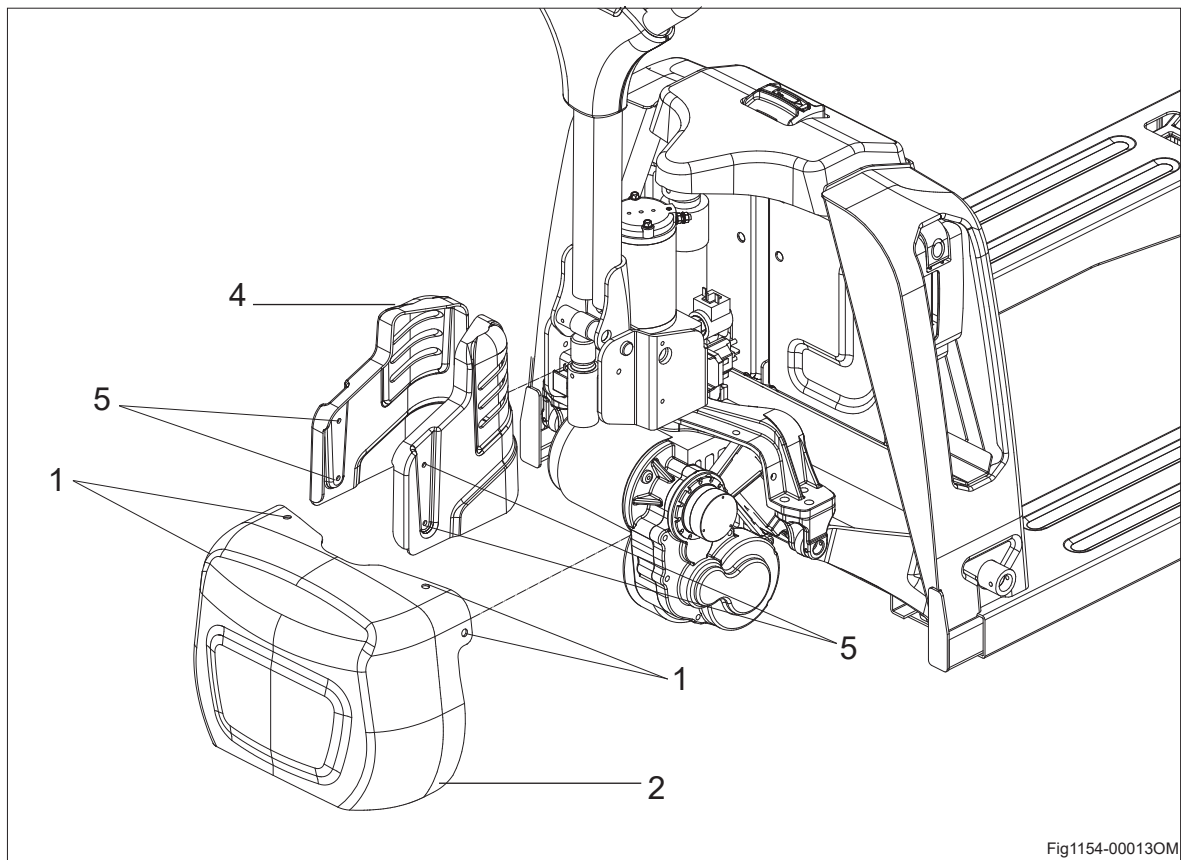

#### **WARNING**

*Remove or install the drive cover, carefully clip hand !*

*When the drive cover is removed, it is dangerous and does not allow operation of the truck.*

### 1.3.3 How to add hydraulic oil

- It is necessary to add hydraulic oil when you heard explosion sound from pipe during lifting. Prepare the truck for maintenance and repairs (See Maintenance Instructions).
- Remove the hydraulic cover.(See chapter D Section 1.3.2).
- Add hydraulic oil of the correct grade (See chapter D Table 1 Lubricants).
- Add hydraulic oil till you can't hear explosion sound during lifting any more.
- Re-installation in the reverse order.

### 1.3.4 How to add grease

- Prepare the truck for maintenance and repairs (See Maintenance Instructions ).
- Remove the driving cover.(See chapter D Section 1.3.2)
- Add grease of the correct grade (See chapter D Table 1 Lubricants ).

Re-installation in the reverse order.



#### **WARNING**

*It is forbidden to add hydraulic oil with impurity.*

### 1.3.5 Checking the fuses

- Fully lower the forks.
- Pull out the supply plug.
- Remove the hydraulic cover(See chapter D Section 1.3.2)
- Fuse 5A installed on main harness. Replace if necessary,

### 1.4 Recommissioning

The truck may only be recommissioned after cleaning or repair work, once the following operations have been performed.

- Test horn.
- Test emergency brake switch.
- Test brake.
- Lubricate the truck in accordance with the maintenance point.
- Do follow the daily checklist.

### 1.5 Final decommissioning, disposal

Final, proper decommissioning or disposal of the truck must be performed in accordance with the regulations of the country of application. In particular, regulations governing the disposal of batteries, fuels, Hydraulic oil, plastic and electronic and electrical systems must be observed.

### 1.6 Tire replacement

The quality of tyres affects the stability and performance of the truck. When replacing tyres fitted at the factory, only use the manufacturer's original spare parts. Otherwise the data sheet specifications of the truck cannot be guaranteed. When changing wheels and tyres, ensure that the truck does not slew (e.g. when replacing wheels always left and right simultaneously).



#### **WARNING**

*Only original tires have been certified by our quality assurance service. To ensure safe and reliable operation of the fork truck, only tires of the manufacturer must be used.*





## Technical data

### Standard Version Specifications

Technical specification details in accordance with VDI 2198. Technical modifications and additions reserved.

### Performance data for standard trucks

Distinguishing mark				
1.1	Manufacturer			EP
1.2	Model designation			F4
1.3	Drive unit			Battery
1.4	Operator type			Pedestrian
1.5	rated capacity	Q	kg	1500
1.6	Load center distance	c	mm	600
1.8	Load distance	x	mm	950
1.9	Wheelbase	y	mm	1180
Weight				
2.1	Service weight (include battery)		kg	120
2.2	Axle loading, laden driving side/loading side		kg	480/1140
2.3	Axle loading, unladen driving side/loading side		kg	90/30
Types, Chassis				
3.1	"Tyre type driving wheels/loading wheels"			PU/PU

3.2.1	Tyre size, driving wheels(diameter×width)		mm	Φ210x70
3.3.1	Tyre size, loading wheels(diameter×width)		mm	Φ80x60(Φ74x88)
3.4	Tyre size, caster wheels(diameter×width)		mm	/
3.5	Wheels, number driving, caster/loading (x=drive wheels)		mm	1x,2/4(1x,2/2)
3.6	Track width, front,driving side	b10	mm	/
3.7	Track width,rear,loading side	b11	mm	410/(535)
<b>Dimensions</b>				
4.4	Lift height	h3	mm	105
4.9	Height drawbar in driving position min./max.	h14	mm	750/1190
4.15	Lowered height	h13	mm	82
4.19	Overall length	l1	mm	1550
4.20	Length to face of forks	l2	mm	325
4.21	Overall width	b1/ b2	mm	695(590)
4.22	Fork dimensions	s/ e/ l	mm	55x150x1150
4.25	Distance between fork-arms	b5	mm	560(685)
4.32	Ground clearance, center of wheelbase	m2	mm	25
4.34.1	Aisle width for pallets 1000 × 1200 crossways	Ast	mm	2160
4.34.2	Aisle width for pallets 800 × 1200 lengthways	Ast	mm	2025
4.35	Turning radius	Wa	mm	1360
<b>Performance data</b>				
5.1	Travel speed, laden/ unladen	km/ h	km/h	4/4.5
5.2	Lifting speed, laden/ unladen		m/ s	0.017/0.020

5.3	Lowering speed, laden/ unladen		fpm	m / s	0.046/0.058
5.8	Max. gradeability, laden/ unladen		%		5\16
5.10	Service brake type				Electroma gnetic
<b>Electric-engine</b>					
6.1	Drive motor rating S2 60 min		hp	kW	0.65
6.2	Lift motor rating at S3 15%		hp	kW	0.5
6.4	Battery voltage/nominal capacity K5		V/ Ah		24/20
6.5	Battery weight		lb.	kg	5
<b>Addition data</b>					
8.1	Type of drive control				DC
10.5	Steering type				mechanical
10.7	Sound pressure level at the driver's ear		dB (A)		<74

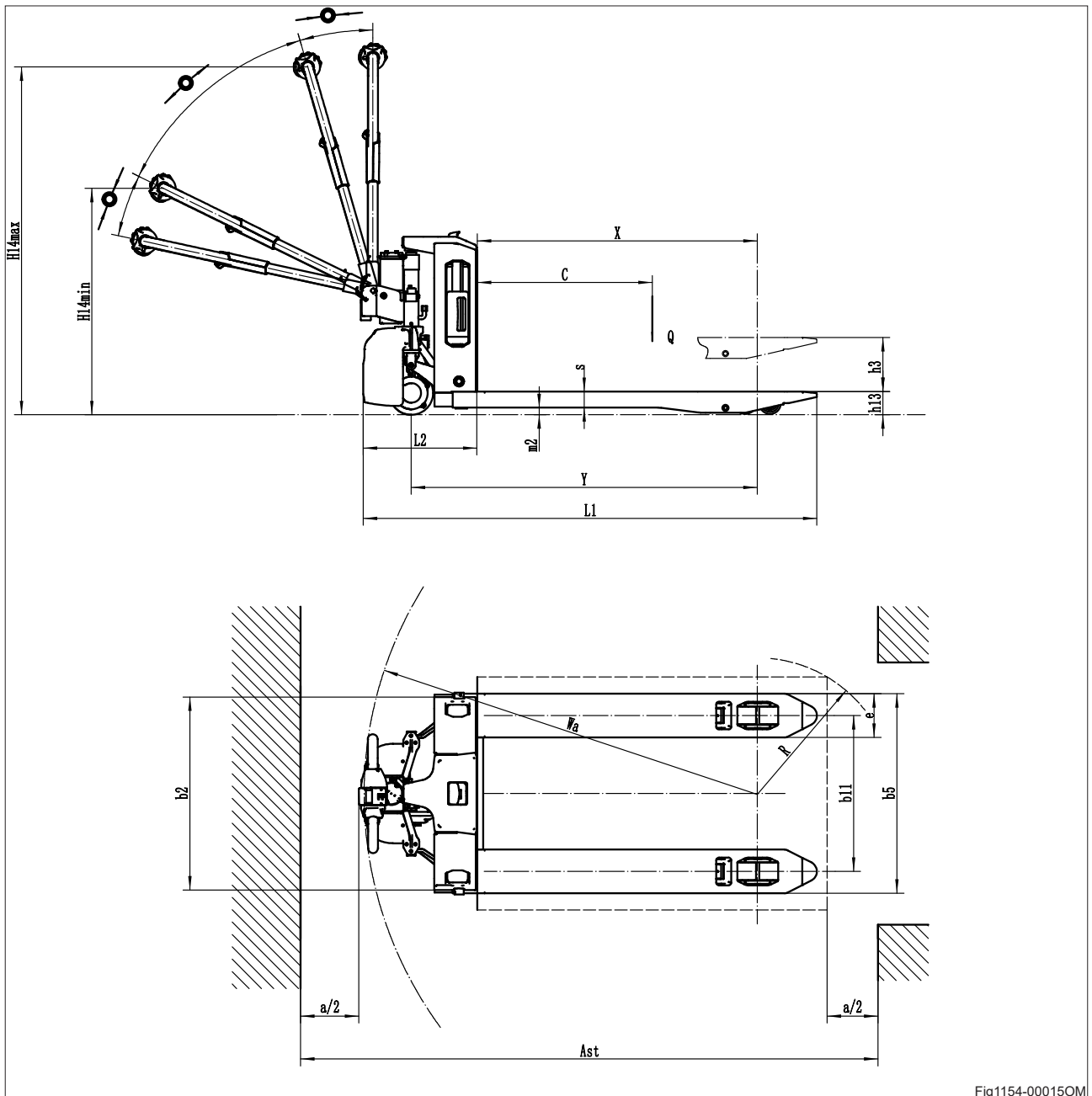

Fig1154-00015OM

<h2>Lithium-ion battery</h2>
------------------------------

## **1 Information on the conformity of lithium-ion batteries**

The manufacturer of the lithium-ion battery declares that: the lithium-ion battery conforms with the provisions of the following EU directive 2014/30/EU in accordance with EN12895.

These batteries has been certified according to EN 62619:2017 for safe use and according to UN38.3 for safe transport.

## **2 It is necessary to respect the following guidelines:**

- Read the documents provided with the battery carefully.
- Only persons who have been trained to work with lithium-ion technology are permitted to work on the batteries (for example After-Sales Service Centre technicians).
- Do not drop it or allow anything to fall on it.
- Do not expose the battery unit to humidity or water ( > 80%).
- Protect the battery from solar irradiation.
- Do not physically machine or modify the battery.
- Do not open the battery. Electrical risk. Only the After-Sales Service Centre technicians can open the battery.
- Do not place lithium-ion batteries on or near flames or hot heat sources (> 65°C). This may cause the batteries to overheat or burst into flames. This type of use also impairs the performance of the batteries and reduces their service life.
- It is forbidden to take out the battery in the charging state state.
- It is forbidden to use and store the battery at low power (the use and storage of power loss will cause the early loss of battery system capacity and accelerate the service life of the battery pack);
- During the charging process, liquid and metal substances are not allowed on the charger, and it is forbidden to use the charger in a high temperature and high humidity environment;
- It is forbidden for unqualified personnel to dismantle and overhaul the battery system and supporting charger and other devices; the battery system is a dangerous product, and maintenance and replacement can only be performed by professionals;
- Before the vehicle is started, power on through the button switch. After the vehicle is stopped, the battery system must be powered off and stopped through the button switch, which can be judged by the state of the display screen. If the time is too long, the battery will be over-discharged. In severe cases, it will affect the battery performance);
- The battery should be fully charged for the first time;
- After each use, it should be charged in time (the initial state of charging should keep the battery system temperature below 40° C to ensure the smoothness of charging);
- Have class D fire extinguishers or inert gas, carbon dioxide, powder or foam fire extinguishers near the zone in which the lithium-ion batteries are used.
- Do only use in trucks manufactured by EP and if the battery type is released for that truck.

### 3 Intended use

- humidity < 80%;
- Charging application temperature 5° C-40° C;
- The battery's maximum operation altitude is up to 2000m;
- Do not pull out the battery for emergency stopping, use instead the supply (see page B13).
- The truck shall not be used in a potentially explosive atmosphere or in an especially dusty environment.

### 4 Reasonably foreseeable misuse

- Never short circuit the battery terminals.
- Do not reverse the battery polarity.
- Do not overcharge.



### **DANGER**

*Failure to comply with these safety instructions can result in fire and explosion or the leakage of harmful materials.*

### 5. Accessories

*Do not use a charger that is not released by EP for lithium-ion battery.*



### **WARNING**

*Should such issues as failing to abide by the operation manual, failing to use the original parts for maintenance or damaging caused by users themselves occur, the quality guarantee will be invalid automatically!*

### 6.BMS (Battery Management System)

The battery is permanently monitored by the BMS (Battery Management System).

This provides the communication with the truck.

The BMS continually monitors items such as the cell temperature, the voltage and the charge status of the cells.

## 7.1 Safety and warning



- Abide by the operation manual!
- All the operations related to the storage battery must be implemented under the instruction of professionals!



Always wear protective clothing (e.g. safety goggles and safety gloves) when working on cells and batteries.



- No smoke and fire!
- Avoid the existence of open fire, fiery metal wire or sparks around the storage battery, otherwise explosion or fire disaster may occur!



- Explosion or fire disaster is likely to occur; avoid short circuit!
- Keep the battery away from all fire sources, heat sources and flammable or explosive materials.



- Don't knock over the storage battery!
- Using lifting and delivery devices as specified. Prevent the storage battery cell, interface and connection cable from being damaged by the lifting hook!
- If the materials leak out, do not inhale the fumes. Wear safety gloves.

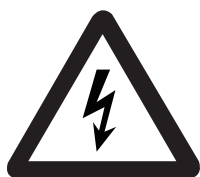

- Dangerous voltage!
- Avoid hot plugging!
- Notice: the metal part of the storage battery cell is electrified, so don't place any external object or tool on the battery cell!



Do not place the battery on top of conductive objects.



- Don't trample on the battery to prevent it from fierce shaking or shacking!



## 8 Transportation

Before transporting any lithium-ion battery, check the current regulations on the transport of dangerous goods. Comply with these when preparing the packaging and transport. Train authorised staff to dispatch lithium-ion batteries.



### NOTE

*It is recommended that the original packaging is kept for any subsequent dispatch.*

*A lithium-ion battery is a special product.*

*Special precautions should be taken when:*

- *Transporting a truck equipped with alithium-ion battery*
- *Transporting only the lithium battery*

*A class 9 danger label must be affixed to the packaging for transport.*

*It is different if the battery is transported on its own or in a truck. An example of a label appears in this supplement(see figure below). Refer to the latest current regulations before dispatch as the information might have changed since this supplement was written.*

*Special documents must be sent with the battery. Refer to the applicable standards or regulations.*

<b>For UN3480</b>	Lithium Ion Batteries	
<b>For UN3481</b>	Lithium Ion Batteries packed with Equipment or Lithium batteries built into Equipment	



### WARNING

*Do not pack higher than 1.2 m above the floor of the container and secure properly.*



### NOTE

*"Overpack" is the name for the outer packaging of the dangerous goods.*



### NOTE

*Recharge the lithium-ion battery before transporting it taking account of the transport mode ( boat, road). Excessive discharge on arrival could damage the performance of the battery.*

### 8.1 Shipping faulty batteries

To transport these faulty lithium-ion batteries, contact the manufacturer's customer service department. Faulty lithium-ion batteries must not be transported independently.

## 9 Instructions for disposal

- Lithium ion batteries must be disposed of in accordance with the relevant environmental protection regulations.
- Used cells and batteries are recyclable economic goods. In accordance with the mark showing a crossed rubbish bin, these batteries may not be disposed of as domestic waste. Return and / or recycling must be ensured as required by the Batteries Legislation.
- The method of battery recovery and reuse can be discussed with our company. We reserve the right to change the technology.

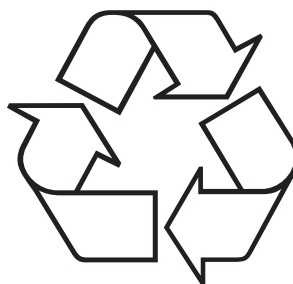
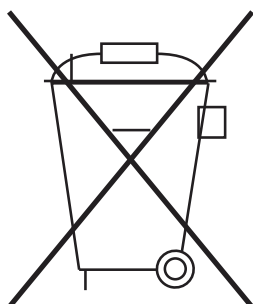

## 10 Charging

- This battery can only be charged with the vehicle-specific charger, other chargers may cause battery damage.
- The normal charging temperature range of the battery is: 5°C ~ 40°C, please do not charge in the environment beyond the normal temperature range;
- If the battery is not fully charged in specified time, check the max. voltage of the cells of the battery, if it is higher than 3.65V, stop charging it immediately, and contact the after-sales service.
- During the charging operation, it is necessary to have professional personnel to operate and care, in order to ensure that the charging plug and socket work normally without heat, to ensure that the charging device works normally, to ensure that the battery pack and its protection circuit work normally, and the whole power supply system has no sign of short circuit, over current, over temperature or overcharge.
- When charging, connect the battery to the charger; after starting charging, the circular display meter will display the total voltage, the maximum and minimum cell voltages, power, temperature, charging current and other information; pay particular attention to the charging current and the maximum and minimum cell voltages, as well as the voltage difference between them; if there is abnormality, stop charging in time and contact the after-sales service department for solutions. Charging in non-charging area is prohibited;
- No modification of vehicles;
- Do not use irregular charging sockets;
- The net height of the charging area shall be higher than 5m, and the safe distance from other areas shall be greater than 5m.



### WARNING

*Do not charge the lithium battery under low temperature environment below 0 °C .*

## 11 Storage

Before a long period of inactivity, the battery must be fully charged.

We recommend that batteries are stored at a height between 60 and 120 cm.

- Store the battery in a dry place at a temperature between 0 and 40° to preserve its service life. This area must not be hermetically sealed to allow air renewal;
- If the battery system needs to be placed on hold for a long time, it would better keep the battery in the semi-electric state and charge the battery every 2 months to ensure that the battery system is in the semi-electric state;
- The positive and negative terminals of the battery system are prohibited from contacting with metal objects during storage.

## 12 Common Problems and Solutions

During the use and maintenance of the lithium-ion battery, the battery or battery system may have one or more of the following abnormal conditions, please organize the professional engineers and technicians to perform the necessary processing according to the instructions in this manual; if you have any questions about the status or solutions, please contact ep dealer or after-sales service department of the company to obtain professional technical support.

- If the battery is found to have abnormal mechanical characteristics such as swelling, cracked casing, melted casing, and distortion of the casing before and during installation, stop using the battery immediately, place it in open and well-ventilated space, and contact the after-sales service.
- If abnormalities such as looseness, cracks, cracks in the insulation layer, burn marks, etc. of the battery's pole pressing bolts, conductive strips, main circuit wires and connectors are found before and during the installation, stop using the battery immediately, check the reason for analysis and give it a fix;
- If the polarity of the positive and negative terminals of the battery is found not match the polarity identification before installation, please stop using the battery immediately and contact the after-sales service department to replace the battery or obtain other solutions;
- If there is fire or smoke happens to the battery, move it to the open air immediately, evacuate people in time, and pour a large amount of cold water onto the battery to cool it down and put out the fire.
- If the battery is found to emit smoke , immediately stop using the battery, using fire sand and explosion-proof box for burial and isolation, wearing respirator and fireproof gloves move the battery to a safe area, notify the after-sales service department of the company for record and obtain technical support;
- If the battery is found to fire, using fire extinguisher(eg. Carbon dioxide extinguisher, Metal fire extinguisher (PM 12i extinguisher), Metal fire extinguisher powder PL 9/78 DIN/EN 3SP-44/95, Dry sand).